

DATA SHEET

Three Phase Induction Motor - Squirrel Cage



Customer		: ASTRAPROM			
Product line		: W22 IE3 Three-Phase		Product code : 12868106	
Frame	: 132S	Cooling method	: IC411 - TEFC		
Insulation class	: F	Mounting	: B5T		
Duty cycle	: S1	Rotation ¹	: Both (CW and CCW)		
Ambient temperature	: -20°C to +40°C	Starting method	: Direct On Line		
Altitude	: 1000 m.a.s.l.	Approx. weight ³	: 63.8 kg		
Protection degree	: IP55	Moment of inertia (J)	: 0.0180 kgm ²		
Design	: N				
Output [kW]	5.5	5.5	5.5	5.5	5.5
Poles	2	2	2	2	2
Frequency [Hz]	50	50	50	50	60
Rated voltage [V]	380/660	400/690	415	460	460
Rated current [A]	10.8/6.20	10.6/6.13	10.6	9.29	9.29
L. R. Amperes [A]	85.1/49.0	83.5/48.4	83.7	81.8	81.8
LRC [A]	7.9	7.9	7.9	8.8	8.8
No load current [A]	3.50/2.02	3.90/2.26	4.20	3.60	3.60
Rated speed [RPM]	2935	2940	2945	3550	3550
Slip [%]	2.17	2.00	1.83	1.39	1.39
Rated torque [Nm]	17.9	17.9	17.8	14.8	14.8
Locked rotor torque [%]	210	229	250	270	270
Breakdown torque [%]	290	320	350	380	380
Service factor	1.00	1.00	1.00	1.00	1.00
Temperature rise	80 K	80 K	80 K	80 K	80 K
Locked rotor time	19s (cold) 11s (hot)	19s (cold) 11s (hot)	21s (cold) 12s (hot)	25s (cold) 14s (hot)	25s (cold) 14s (hot)
Noise level ²	63.0 dB(A)	63.0 dB(A)	63.0 dB(A)	68.0 dB(A)	68.0 dB(A)
Efficiency (%)	25%				
	50%	87.6	86.9	86.1	84.7
	75%	88.9	88.7	88.3	87.6
	100%	89.2	89.4	89.2	89.5
Power Factor	25%				
	50%	0.71	0.66	0.61	0.65
	75%	0.82	0.78	0.74	0.77
	100%	0.87	0.84	0.81	0.83
Losses at normative operating points (speed;torque), in percentage of rated output power					
Losses (%)	P1 (0,9;1,0)	12.0	11.8	12.0	11.7
	P2 (0,5;1,0)	10.4	10.2	10.4	10.1
	P3 (0,25;1,0)	9.0	8.8	9.0	8.7
	P4 (0,9;0,5)	5.6	5.5	5.6	5.5
	P5 (0,5;0,5)	3.8	3.7	3.8	3.6
	P6 (0,5;0,25)	2.4	2.3	2.4	2.3
	P7 (0,25;0,25)	1.6	1.6	1.6	1.5
Bearing type	: Drive end 6308 ZZ	Non drive end 6207 ZZ	Foundation loads		
Sealing	: Oil Seal	Lip Seal	Max. traction	: 728 N	
Lubrication interval	: -	-	Max. compression	: 1354 N	
Lubricant amount	: -	-			
Lubricant type	: 00088				
This revision replaces and cancel the previous one, which must be eliminated. (1) Looking the motor from the shaft end. (2) Measured at 1m and with tolerance of +3dB(A). (3) Approximate weight subject to changes after manufacturing process. (4) At 100% of full load.			These are average values based on tests with sinusoidal power supply, subject to the tolerances stipulated in IEC 60034-1.		
Rev.	Changes Summary		Performed	Checked	Date
Performed by					
Checked by				Page	Revision
Date	27/03/2026			1 / 3	

DATA SHEET

Three Phase Induction Motor - Squirrel Cage



Customer : ASTRAPROM

Notes

Rev.	Changes Summary	Performed	Checked	Date
Performed by				
Checked by			Page	Revision
Date	27/03/2026		2 / 3	

DATA SHEET



Three Phase Induction Motor - Squirrel Cage

Customer : ASTRAPROM

Thermal protection

ID	Application	Type	Quantity	Sensing Temperature
1	Winding	Thermistor - 2 wires	1 x Phase	155 °C

Rev.	Changes Summary	Performed	Checked	Date
Performed by				Page 3 / 3
Checked by				
Date	27/03/2026			
				Revision

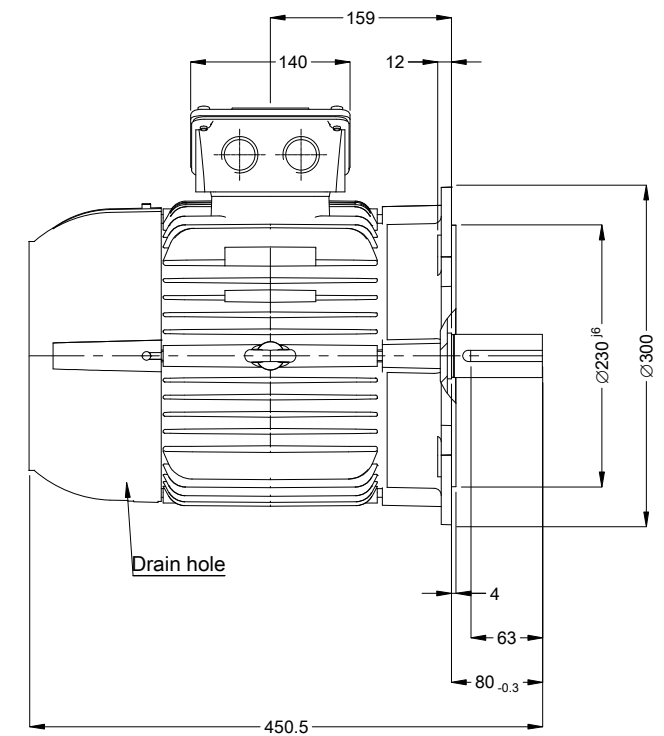
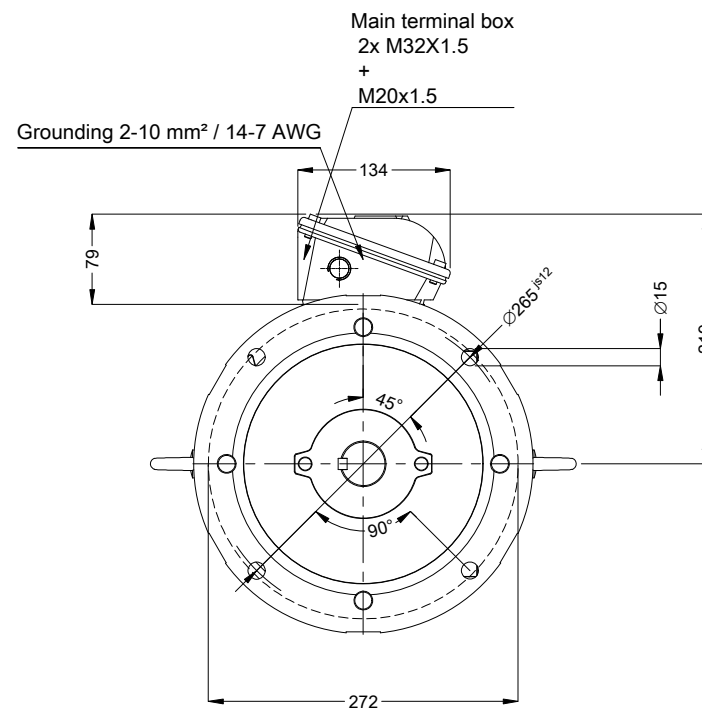
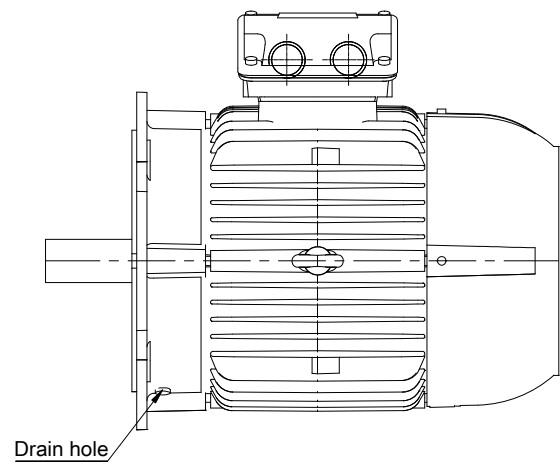

A
B
C

D

E	Sealing - oil seal ring
	Bearing cap
	Thermal protection to switch off - thermistors 155°C
	Color RAL 5009
	Painting plan 207A
	Mounting B5T

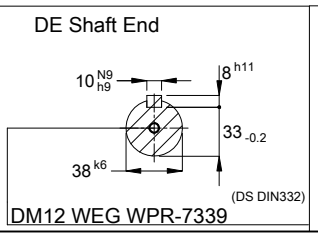

5.5 kW 02 Poles 50 Hz A

Scale 2 : 13

ECM	LOC	SUMMARY OF MODIFICATIONS	HYBRISUSER					00
EXECUTED	HYBRISUSER		EXECUTED	CHECKED	RELEASED	DATE	VER	
CHECKED		THREE PH. MOTOR W22 IE3 FRAME 132S IP55 TEFC	PREVIEW					
RELEASED			WDD	00				
REL. DATE			SHEET	1 / 1				