

DATA SHEET

Three Phase Induction Motor - Squirrel Cage



Customer		: ASTRAPROM			
Product line		: Multimounting IE3 Three-Phase		Product code : 15448742	
Frame	: S132S	Cooling method	: IC411 - TEFC		
Insulation class	: F	Mounting	: B5T		
Duty cycle	: S1	Rotation ¹	: Both (CW and CCW)		
Ambient temperature	: -20°C to +40°C	Starting method	: Direct On Line		
Altitude	: 1000 m.a.s.l.	Approx. weight ³	: 62.4 kg		
Protection degree	: IP55	Moment of inertia (J)	: 0.0528 kgm ²		
Design	: N				
Output [kW]	5.5	5.5	5.5	5.5	5.5
Poles	4	4	4	4	4
Frequency [Hz]	50	50	50	50	60
Rated voltage [V]	220/380	230/400	240/415	460	
Rated current [A]	18.5/10.7	18.1/10.4	17.8/10.3	9.07	
L. R. Amperes [A]	157/90.9	154/88.4	151/87.6	80.7	
LRC [A]	8.5	8.5	8.5	8.9	
No load current [A]	7.60/4.40	8.17/4.70	8.82/5.10	4.43	
Rated speed [RPM]	1460	1465	1470	1765	
Slip [%]	2.67	2.33	2.00	1.94	
Rated torque [Nm]	36.0	35.9	35.7	29.8	
Locked rotor torque [%]	210	240	260	260	
Breakdown torque [%]	300	340	370	430	
Service factor	1.00	1.00	1.00	1.00	
Temperature rise	80 K	80 K	80 K	80 K	
Locked rotor time	27s (cold) 15s (hot)	27s (cold) 15s (hot)	27s (cold) 15s (hot)	32s (cold) 18s (hot)	
Noise level ²	56.0 dB(A)	56.0 dB(A)	56.0 dB(A)	58.0 dB(A)	
Efficiency (%)	25%				
	50%	89.0	89.0	89.0	88.5
	75%	89.5	89.5	89.5	91.0
	100%	89.6	89.6	89.6	91.7
Power Factor	25%				
	50%	0.71	0.67	0.64	0.65
	75%	0.82	0.79	0.76	0.77
	100%	0.87	0.85	0.83	0.83
Losses at normative operating points (speed;torque), in percentage of rated output power					
Losses (%)	P1 (0,9;1,0)	10.5	10.0	9.9	8.9
	P2 (0,5;1,0)	9.2	8.8	8.7	7.8
	P3 (0,25;1,0)	8.8	8.4	8.3	7.4
	P4 (0,9;0,5)	4.9	4.7	4.7	4.2
	P5 (0,5;0,5)	3.5	3.4	3.3	3.0
	P6 (0,5;0,25)	2.3	2.2	2.2	1.9
	P7 (0,25;0,25)	1.6	1.6	1.6	1.4
Bearing type	: Drive end 6308 ZZ	Non drive end 6207 ZZ	Foundation loads		
Sealing	: Oil Seal	Oil Seal	Max. traction : 0 N		
Lubrication interval	: -	-	Max. compression : 0 N		
Lubricant amount	: -	-			
Lubricant type	: Mobil Polyrex EM				
This revision replaces and cancel the previous one, which must be eliminated. (1) Looking the motor from the shaft end. (2) Measured at 1m and with tolerance of +3dB(A). (3) Approximate weight subject to changes after manufacturing process. (4) At 100% of full load.			These are average values based on tests with sinusoidal power supply, subject to the tolerances stipulated in IEC 60034-1.		
Rev.	Changes Summary		Performed	Checked	Date
Performed by					
Checked by				Page	Revision
Date	02/04/2026			1 / 3	

DATA SHEET

Three Phase Induction Motor - Squirrel Cage



Customer : ASTRAPROM

Notes

Rev.	Changes Summary	Performed	Checked	Date
Performed by				
Checked by			Page	Revision
Date	02/04/2026		2 / 3	

DATA SHEET



Three Phase Induction Motor - Squirrel Cage

Customer : ASTRAPROM

Thermal protection

ID	Application	Type	Quantity	Sensing Temperature
1	Winding	Thermistor - 2 wires	1 x Phase	155 °C

Rev.	Changes Summary	Performed	Checked	Date
Performed by				Page 3 / 3
Checked by				
Date	02/04/2026			
				Revision

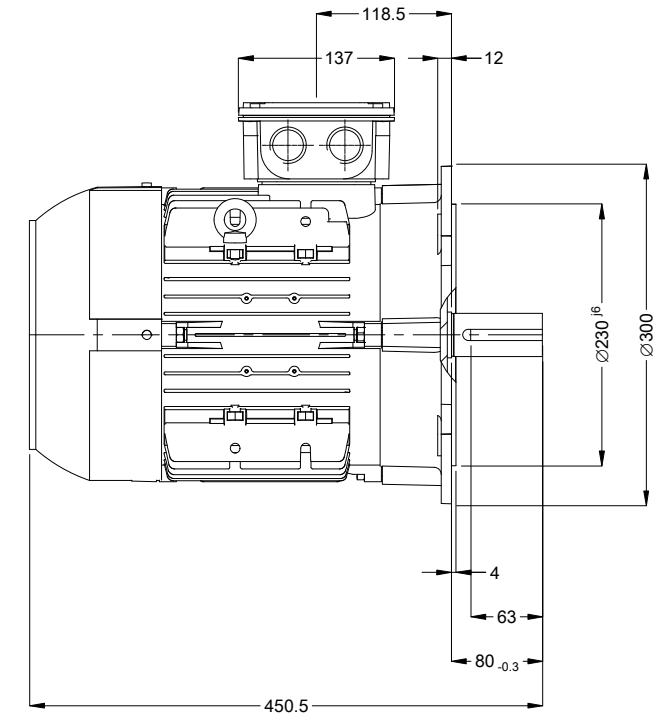
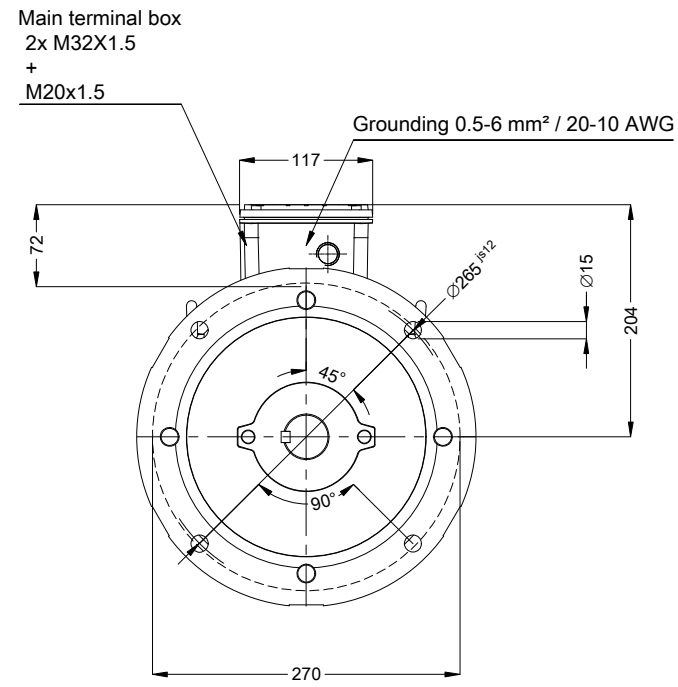
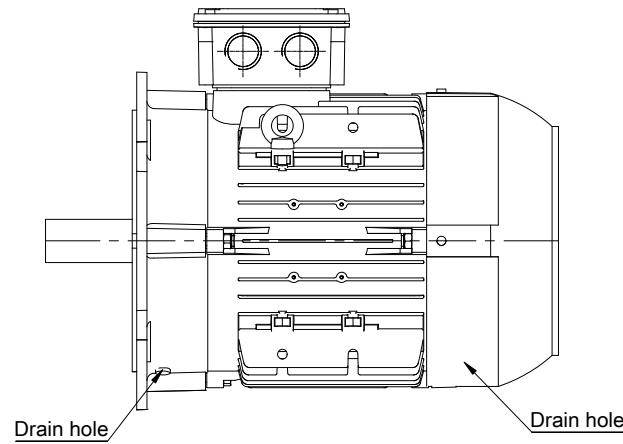

5.5 kW 04 Poles 50 Hz

Scale 2 : 13

- NDE sealing - lip seal
- Sealing - oil seal ring
- Bearing cap
- Thermal protection to switch off - thermistors 155°C
- Color RAL 5009
- Painting plan 207A
- Mounting B5T

DE Shaft End

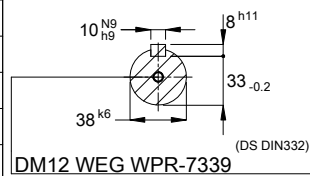

ECM	LOC	SUMMARY OF MODIFICATIONS	EXECUTED	CHECKED	RELEASED	DATE	VER
EXECUTED	HYBRISUSER	THREE PH. MOTOR MULTIMOUNTIN TOP PREM. EFF.					
CHECKED		FRAME S132S IP55 TEFC					
RELEASED							
REL. DATE							

PREVIEW

WDD 00

SHEET 1 / 1

