

**FAG****61808-2RSR>N**

Deep groove ball bearing

Deep groove ball bearing 618..-2RSR, single row, seals, steel sheet metal cage

Schaeffler ID:
0896158240000

Technical information

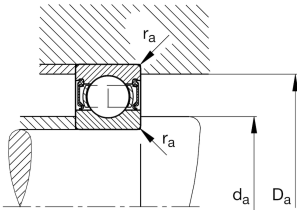
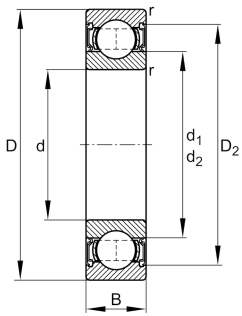
**Your current product variant**

Version code	>N	Not marked on bearing
Sealing	2RSR	Contact seal on both sides
Cage	J	Steel sheet metal
Tolerance class	PN	Normal (PN)
Dimensional / heat stabilization	SN	Rings dimensional stabilized up to 120°
Lubricant	Lubricating grease	
Radial internal clearance	CN (Group N)	Normal internal clearance
Bore type	Z	Cylindrical

Main Dimensions & Performance Data

d	40 mm	Bore diameter
D	52 mm	Outside diameter
B	7 mm	Width
C _r	4.930 N	Basic dynamic load rating, radial
C _{0r}	4.180 N	Basic static load rating, radial
C _{ur}	255 N	Fatigue load limit, radial
n _G	6.200 1/min	Limiting speed
≈m	0,032 kg	Weight



Mounting dimensions

$d_{a \min}$	42 mm	Minimum diameter shaft shoulder
$D_{a \max}$	50 mm	Maximum diameter of housing shoulder
$r_{a \max}$	0,3 mm	Maximum fillet radius

Dimensions

r_{\min}	0,3 mm	Minimum chamfer dimension
D_2	49,9 mm	Caliber diameter outer ring
d_1	43,2 mm	Shoulder diameter inner ring

Temperature range

T_{\min}	-30 °C	Operating temperature min.
T_{\max}	100 °C	Operating temperature max.

Calculation factors

f_0	16,3	Calculation factor
-------	------	--------------------

Characteristics



Radial load



Axial load in one direction



Axial load in two directions



Lifetime lubrication, freedom from maintenance



Grease Lubrication



Sealed on both sides