

**FAG****6416-M**

Deep groove ball bearing

Deep groove ball bearing 64.-M, single row,
solid brass cageSchaeffler ID:
0191127180000

Technical information

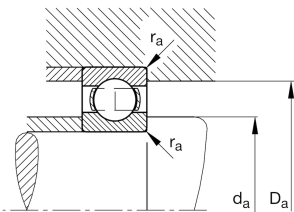
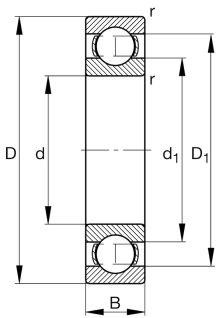

Your current product variant

| | | |
|----------------------------------|--------------|--|
| Sealing | Without | Not sealed |
| Cage | M | Solid brass cage, rolling element guided |
| Tolerance class | PN | Normal (PN) |
| Dimensional / heat stabilization | S0 | Rings dimensional stabilized up to 150° |
| Lubricant | Without | Bearing not greased |
| Radial internal clearance | CN (Group N) | Normal internal clearance |
| Bore type | Z | Cylindrical |

Main Dimensions & Performance Data

| | | |
|----------|-------------|-----------------------------------|
| d | 80 mm | Bore diameter |
| D | 200 mm | Outside diameter |
| B | 48 mm | Width |
| C_r | 173.000 N | Basic dynamic load rating, radial |
| C_{0r} | 125.000 N | Basic static load rating, radial |
| C_{ur} | 7.100 N | Fatigue load limit, radial |
| n_G | 5.900 1/min | Limiting speed |
| n_{gr} | 5.400 1/min | Reference speed |
| m | 8,29 kg | Weight |



Mounting dimensions

| | | |
|--------------|--------|--------------------------------------|
| $d_{a \min}$ | 96 mm | Minimum diameter shaft shoulder |
| $D_{a \max}$ | 184 mm | Maximum diameter of housing shoulder |
| $r_{a \max}$ | 2,5 mm | Maximum fillet radius |

Dimensions

| | | |
|------------|-----------|------------------------------|
| r_{\min} | 3 mm | Minimum chamfer dimension |
| D_1 | 162,14 mm | Shoulder diameter outer ring |
| d_1 | 117,94 mm | Shoulder diameter inner ring |

Temperature range

| | | |
|------------|--------|----------------------------|
| T_{\min} | -30 °C | Operating temperature min. |
| T_{\max} | 150 °C | Operating temperature max. |

Calculation factors

| | | |
|-------|------|--------------------|
| f_0 | 12,3 | Calculation factor |
|-------|------|--------------------|

Characteristics

| | |
|---|------------------------------|
|  | Radial load |
|  | Axial load in one direction |
|  | Axial load in two directions |
|  | Grease Lubrication |
|  | Oil Lubrication |
|  | Not sealed |