

**FAG****61900-2RSR>N**

Deep groove ball bearing

Deep groove ball bearing 619..-2RSR, single row, seals, steel sheet metal cage

Schaeffler ID:  
0833503810000

## Technical information

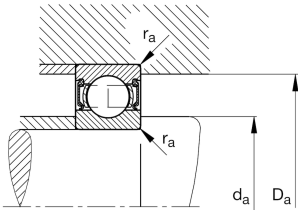
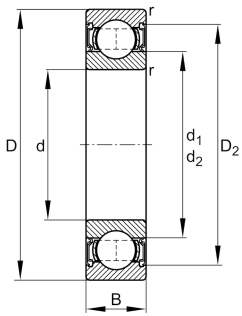
**Your current product variant**

Version code	>N	Not marked on bearing
Sealing	2RSR	Contact seal on both sides
Cage	J	Steel sheet metal
Tolerance class	PN	Normal (PN)
Dimensional / heat stabilization	SN	Rings dimensional stabilized up to 120°
Lubricant	Lubricating grease	
Radial internal clearance	CN (Group N)	Normal internal clearance
Bore type	Z	Cylindrical

**Main Dimensions & Performance Data**

d	10 mm	Bore diameter
D	22 mm	Outside diameter
B	6 mm	Width
C <sub>r</sub>	2.700 N	Basic dynamic load rating, radial
C <sub>0r</sub>	1.270 N	Basic static load rating, radial
C <sub>ur</sub>	97 N	Fatigue load limit, radial
n <sub>G</sub>	19.200 1/min	Limiting speed
≈m	0,01 kg	Weight



### Mounting dimensions

$d_{a \min}$	12 mm	Minimum diameter shaft shoulder
$D_{a \max}$	20 mm	Maximum diameter of housing shoulder
$r_{a \max}$	0,3 mm	Maximum fillet radius

### Dimensions

$r_{\min}$	0,3 mm	Minimum chamfer dimension
$D_2$	19,22 mm	Caliber diameter outer ring
$d_2$	13,1 mm	Caliber diameter inner ring





### Temperature range

$T_{\min}$	-30 °C	Operating temperature min.
$T_{\max}$	100 °C	Operating temperature max.

### Calculation factors

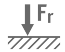
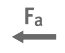
$f_0$	14	Calculation factor
-------	----	--------------------

### Characteristics

-  Radial load
-  Axial load in one direction
-  Axial load in two directions
-  Lifetime lubrication, freedom from maintenance
-  Grease Lubrication
-  Sealed on both sides