

**FAG****61800-2RSR>N**

Deep groove ball bearing

Deep groove ball bearing 618...2RSR, single row, seals, steel sheet metal cage

Schaeffler ID:
3004560260000

Technical information

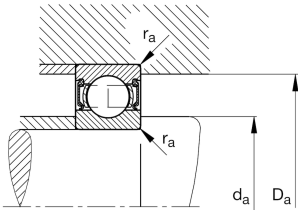
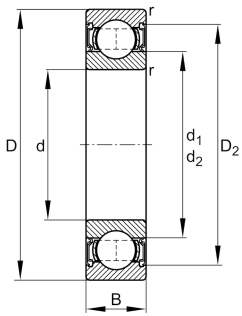

Your current product variant

Version code	>N	Not marked on bearing
Sealing	2RSR	Contact seal on both sides
Cage	J	Steel sheet metal
Tolerance class	PN	Normal (PN)
Dimensional / heat stabilization	SN	Rings dimensional stabilized up to 120°
Lubricant	Lubricating grease	
Radial internal clearance	CN (Group N)	Normal internal clearance
Bore type	Z	Cylindrical

Main Dimensions & Performance Data

d	10 mm	Bore diameter
D	19 mm	Outside diameter
B	5 mm	Width
C _r	1.720 N	Basic dynamic load rating, radial
C _{0r}	810 N	Basic static load rating, radial
C _{ur}	58 N	Fatigue load limit, radial
n _G	21.000 1/min	Limiting speed
≈m	0,006 kg	Weight



Mounting dimensions

$d_{a \min}$	12 mm	Minimum diameter shaft shoulder
$D_{a \max}$	17 mm	Maximum diameter of housing shoulder
$r_{a \max}$	0,3 mm	Maximum fillet radius

Dimensions

r_{\min}	0,3 mm	Minimum chamfer dimension
D_2	17,42 mm	Caliber diameter outer ring
d_2	12,2 mm	Caliber diameter inner ring





Temperature range

T_{\min}	-30 °C	Operating temperature min.
T_{\max}	120 °C	Operating temperature max.

Calculation factors

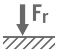
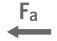
f_0	13,1	Calculation factor
-------	------	--------------------

Characteristics

	Radial load
	Axial load in one direction
	Axial load in two directions
	Lifetime lubrication, freedom from maintenance
	Grease Lubrication
	Sealed on both sides