



FAG

**SES522-619-L**

Plummer block housing

Schaeffler ID:  
0860886290000

Split plummer block housing for various bearing designs. The SNV series will be replaced by the new SES series in 2022.

## Technical information

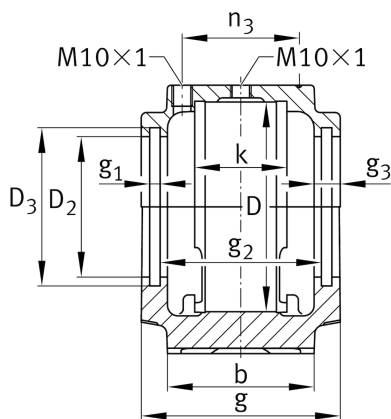
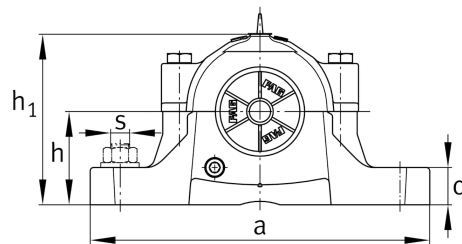
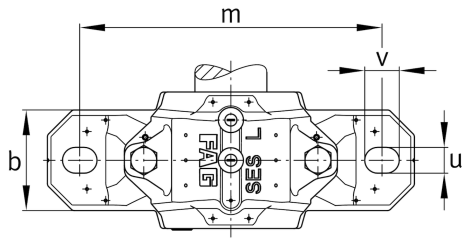
**Main Dimensions & Performance Data**

D	200,00 mm	outside diameter bearing
a	410,00 mm	length base
h <sub>1</sub>	242,00 mm	height
g	175,00 mm	width housing body
K	80,00 mm	Width bearing seat
	22,80 kg	Weight

**Dimensions**

b	120,00 mm	width base
c	45,00 mm	height base
h	125,00 mm	center height
m	350,00 mm	distance fixing bore
s	0,88 inch	screw size
s	M24	size of fixing screws
u	26,00 mm	width slot
v	32,00 mm	length slot
D <sub>2</sub>	147,50 mm	diameter sealing
D <sub>3</sub>	157,50 mm	diameter sealing groove
D <sub>5</sub>	154,70 mm	Outside diameter sealing labyrinth
g <sub>1</sub>	6,00 mm	Width sealing groove
g <sub>2</sub>	155,00 mm	Distance sealing
g <sub>3</sub>	14,00 mm	Wall thickness
g <sub>4</sub>	37,50 mm	Distance oil lubrication
m <sub>1</sub>	296,00 mm	Distance holes aligned pins m1
n <sub>3</sub>	111,00 mm	Distance lubrication
n <sub>4</sub>	157,00 mm	Distance lubrication sealing
u <sub>1</sub>	8,00 mm	bore diameter u1
u <sub>2</sub>	18,00 mm	bore diameter u2