



FAG

SES519-616-L

Plummer block housing

Schaeffler ID:
0860886020000

Split plummer block housing for various bearing designs. The SNV series will be replaced by the new SES series in 2022.

Technical information

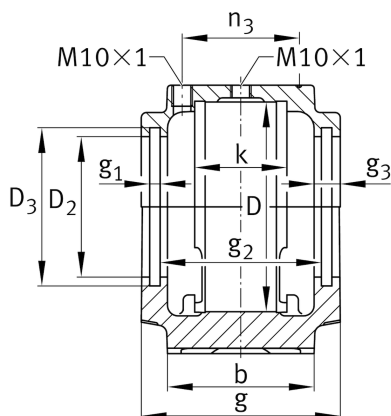
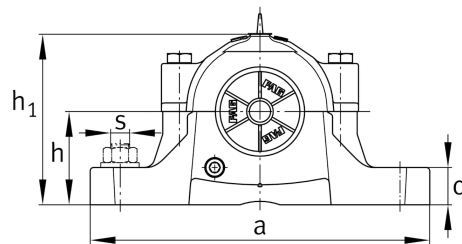
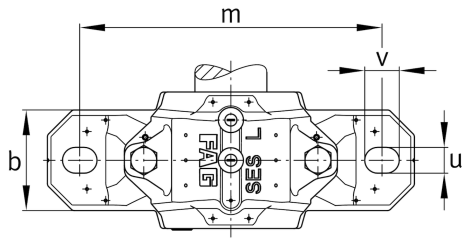
**Main Dimensions & Performance Data**

D	170,00 mm	outside diameter bearing
a	345,00 mm	length base
h ₁	212,00 mm	height
g	145,00 mm	width housing body
K	68,00 mm	Width bearing seat
	13,80 kg	Weight

Dimensions

b	100,00 mm	width base
c	35,00 mm	height base
h	112,00 mm	center height
m	290,00 mm	distance fixing bore
s	0,75 inch	screw size
s	M20	size of fixing screws
u	22,00 mm	width slot
v	28,00 mm	length slot
D ₂	131,00 mm	diameter sealing
D ₃	141,00 mm	diameter sealing groove
D ₅	138,20 mm	Outside diameter sealing labyrinth
g ₁	6,00 mm	Width sealing groove
g ₂	125,00 mm	Distance sealing
g ₃	14,00 mm	Wall thickness
g ₄	38,00 mm	Distance oil lubrication
m ₁	250,00 mm	Distance holes aligned pins m1
n ₃	86,00 mm	Distance lubrication
n ₄	128,00 mm	Distance lubrication sealing
u ₁	8,00 mm	bore diameter u1
u ₂	18,00 mm	bore diameter u2