



FAG

SES516-613-L

Plummer block housing

Schaeffler ID:
0860885560000Split plummer block housing for various
bearing designs

Technical information

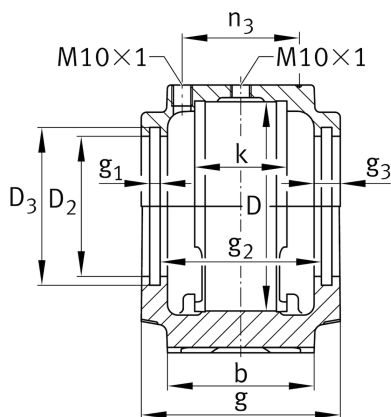
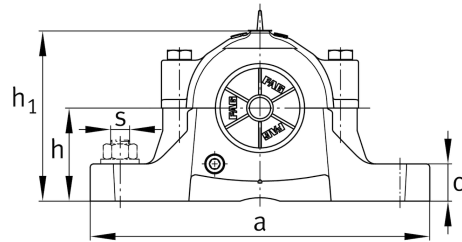
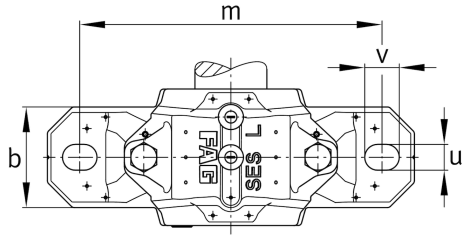
**Main Dimensions & Performance Data**

| | | |
|-------|--------|--------------------------|
| D | 140 mm | outside diameter bearing |
| a | 315 mm | length base |
| h_1 | 177 mm | height |
| g | 120 mm | width housing body |
| K | 58 mm | Width bearing seat |
| | 9,3 kg | Weight |

Dimensions

| | | |
|-------|---------|------------------------------------|
| b | 90 mm | width base |
| c | 32 mm | height base |
| h | 95 mm | center height |
| m | 260 mm | distance fixing bore |
| s | 0,75 | screw size |
| s | M20 | size of fixing screws |
| u | 22 mm | width slot |
| v | 28 mm | length slot |
| D_2 | 92,5 mm | diameter sealing |
| D_3 | 101 mm | diameter sealing groove |
| D_5 | 98,7 mm | Outside diameter sealing labyrinth |
| g_1 | 5 mm | Width sealing groove |
| g_2 | 102 mm | Distance sealing |
| g_3 | 13 mm | Wall thickness |
| g_4 | 36 mm | Distance oil lubrication |
| m_1 | 218 mm | Distance holes aligned pins m_1 |
| n_3 | 77 mm | Distance lubrication |
| n_4 | 106 mm | Distance lubrication sealing |
| u_1 | 8 mm | bore diameter u_1 |
| u_2 | 18 mm | bore diameter u_2 |