



FAG

**SES512-610-L**

Plummer block housing

Schaeffler ID:  
0860884910000

Split plummer block housing for various bearing designs. The SNV series will be replaced by the new SES series in 2022.

## Technical information

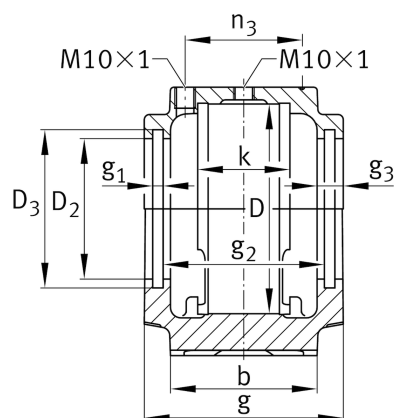
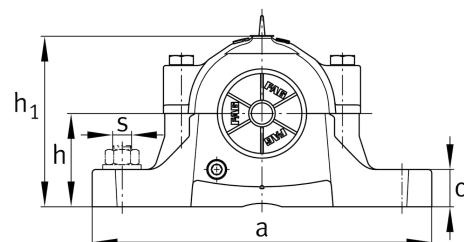
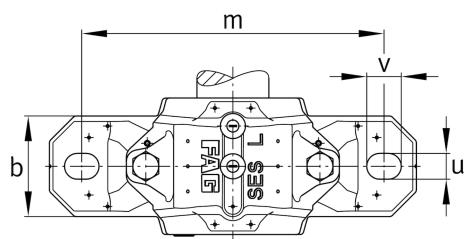
**Main Dimensions & Performance Data**

D	110,00 mm	outside diameter bearing
a	255,00 mm	length base
h <sub>1</sub>	134,00 mm	height
g	105,00 mm	width housing body
K	48,00 mm	Width bearing seat
	5,20 kg	Weight

**Dimensions**

b	70,00 mm	width base
c	30,00 mm	height base
h	70,00 mm	center height
m	210,00 mm	distance fixing bore
s	0,62 inch	screw size
s	M16	size of fixing screws
u	18,00 mm	width slot
v	24,00 mm	length slot
D <sub>2</sub>	72,00 mm	diameter sealing
D <sub>3</sub>	80,50 mm	diameter sealing groove
D <sub>5</sub>	78,20 mm	Outside diameter sealing labyrinth
g <sub>1</sub>	5,00 mm	Width sealing groove
g <sub>2</sub>	87,00 mm	Distance sealing
g <sub>3</sub>	12,00 mm	Wall thickness
g <sub>4</sub>	37,00 mm	Distance oil lubrication
m <sub>1</sub>	174,00 mm	Distance holes aligned pins m1
n <sub>3</sub>	62,00 mm	Distance lubrication
n <sub>4</sub>	90,00 mm	Distance lubrication sealing
u <sub>1</sub>	6,00 mm	bore diameter u1
u <sub>2</sub>	14,00 mm	bore diameter u2