



FAG

## SES216-L

Plummer block housing

Schaeffler ID:  
0860885480000

Split plummer block housing for various bearing designs. The SNV series will be replaced by the new SES series in 2022.

## Technical information

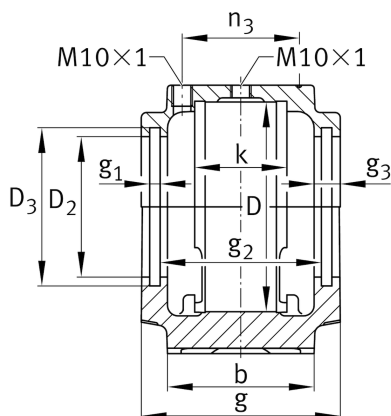
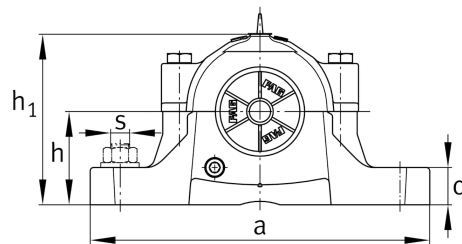
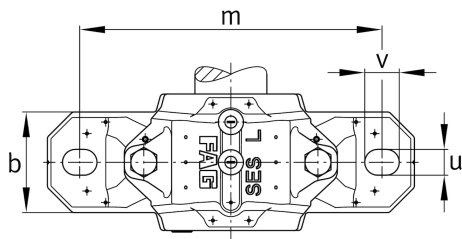

## Main Dimensions &amp; Performance Data

D	140,00 mm	outside diameter bearing
a	315,00 mm	length base
h <sub>1</sub>	177,00 mm	height
g	120,00 mm	width housing body
K	58,00 mm	Width bearing seat
	8,80 kg	Weight

## Dimensions

b	90,00 mm	width base
c	32,00 mm	height base
h	95,00 mm	center height
m	260,00 mm	distance fixing bore
s	0,75 inch	screw size
s	M20	size of fixing screws
u	22,00 mm	width slot
v	28,00 mm	length slot
D <sub>2</sub>	108,00 mm	diameter sealing
D <sub>3</sub>	116,50 mm	diameter sealing groove
D <sub>5</sub>	114,20 mm	Outside diameter sealing labyrinth
g <sub>1</sub>	5,00 mm	Width sealing groove
g <sub>2</sub>	102,00 mm	Distance sealing
g <sub>3</sub>	13,00 mm	Wall thickness
g <sub>4</sub>	36,00 mm	Distance oil lubrication
m <sub>1</sub>	218,00 mm	Distance holes aligned pins m1
n <sub>3</sub>	77,00 mm	Distance lubrication
n <sub>4</sub>	106,00 mm	Distance lubrication sealing
u <sub>1</sub>	8,00 mm	bore diameter u1
u <sub>2</sub>	18,00 mm	bore diameter u2