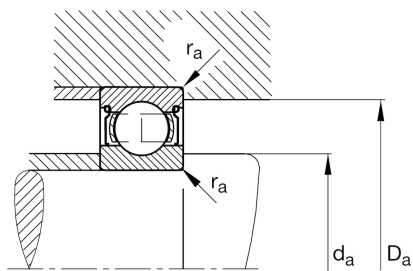
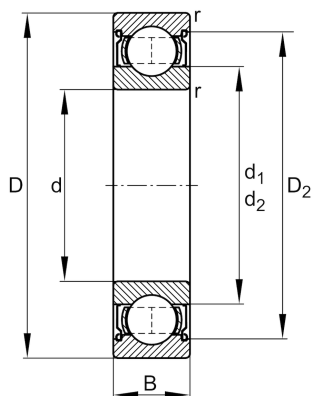

**FAG****696-2Z**

Deep groove ball bearing

Schaeffler ID:
0554727880000Deep groove ball bearing 69...-2Z, single
row, shields, steel sheet metal cage

Technical information

**Main Dimensions & Performance Data**

d	6 mm	Bore diameter
D	15 mm	Outside diameter
B	5 mm	Width
C_r	1.340 N	Basic dynamic load rating, radial
C_{0r}	517 N	Basic static load rating, radial
C_{ur}	14,1 N	Fatigue load limit, radial
n_G	57.000 1/min	Limiting speed
	4 g	Weight

Mounting dimensions

$d_{a \min}$	7,4 mm	Minimum diameter shaft shoulder
$D_{a \max}$	13,6 mm	Maximum diameter of housing shoulder

Dimensions

r_{\min}	0,2 mm	Minimum chamfer dimension
D_2	13 mm	Caliber diameter outer ring
d_2	7,5 mm	Caliber diameter inner ring

Temperature range

T_{\min}	-30 °C	Operating temperature min.
T_{\max}	120 °C	Operating temperature max.

Calculation factors

f_0	13	Calculation factor
-------	----	--------------------