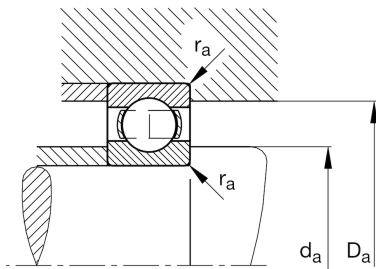
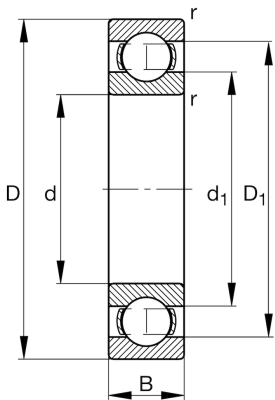

**FAG****6413**

Deep groove ball bearing

Schaeffler ID:  
0167248010000Deep groove ball bearing 64, single row,  
steel sheet metal cage

## Technical information

**Main Dimensions & Performance Data**

d	65 mm	Bore diameter
D	160 mm	Outside diameter
B	37 mm	Width
$C_r$	123.000 N	Basic dynamic load rating, radial
$C_{0r}$	77.000 N	Basic static load rating, radial
$C_{ur}$	4.850 N	Fatigue load limit, radial
$n_G$	6.300 1/min	Limiting speed
$n_{gr}$	5.600 1/min	Reference speed
	3,49 kg	Weight

**Mounting dimensions**

$d_{a \min}$	79 mm	Minimum diameter shaft shoulder
$D_{a \max}$	146 mm	Maximum diameter of housing shoulder
$r_{a \max}$	2,1 mm	Maximum fillet radius

**Dimensions**

$r_{\min}$	2,1 mm	Minimum chamfer dimension
$D_1$	133,3 mm	Shoulder diameter outer ring
$d_1$	101,7 mm	Shoulder diameter inner ring

**Temperature range**

$T_{\min}$	-30 °C	Operating temperature min.
$T_{\max}$	150 °C	Operating temperature max.

**Calculation factors**

$f_0$	13,2	Calculation factor
-------	------	--------------------