



FAG

**6328-M-C3**

Deep groove ball bearing

Schaeffler ID:  
0191120500030Deep groove ball bearing 63..-M, single  
row, solid brass cage

## Technical information

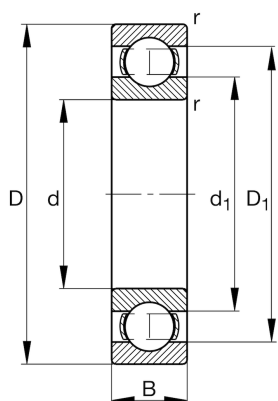
**Main Dimensions & Performance Data**

d	140 mm	Bore diameter
D	300 mm	Outside diameter
B	62 mm	Width
$C_r$	270.000 N	Basic dynamic load rating, radial
$C_{0r}$	246.000 N	Basic static load rating, radial
$C_{ur}$	11.500 N	Fatigue load limit, radial
$n_G$	3.850 1/min	Limiting speed
$n_{gr}$	3.250 1/min	Reference speed
	21,93 kg	{Weight}

**Mounting dimensions**

$d_{a \min}$	157 mm	Minimum diameter shaft shoulder
$D_{a \max}$	283 mm	Maximum diameter of housing shoulder
$r_{a \max}$	3 mm	Maximum fillet radius

**Dimensions**

$r_{\min}$	4 mm	Minimum chamfer dimension
$D_1$	248,8 mm	Shoulder diameter outer ring
$d_1$	191,2 mm	Shoulder diameter inner ring

**Temperature range**

$T_{\min}$	-30 °C	Operating temperature min.
$T_{\max}$	200 °C	Operating temperature max.

**Calculation factors**

$f_0$	13,6	Calculation factor
-------	------	--------------------