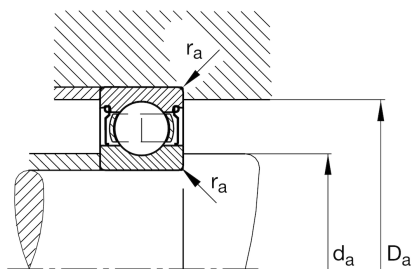
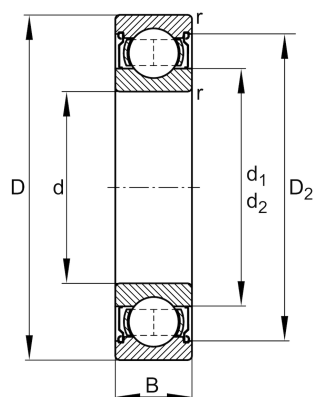
**FAG****6316-2Z**

Deep groove ball bearing

Schaeffler ID:  
0167241860000Deep groove ball bearing 63...-2Z, single  
row, shields, steel sheet metal cage

## Technical information

**Main Dimensions & Performance Data**

d	80 mm	Bore diameter
D	170 mm	Outside diameter
B	39 mm	Width
$C_r$	131.000 N	Basic dynamic load rating, radial
$C_{0r}$	87.000 N	Basic static load rating, radial
$C_{ur}$	5.400 N	Fatigue load limit, radial
$n_G$	4.550 1/min	Limiting speed
$n_{gr}$	5.500 1/min	Reference speed
	3,75 kg	Weight

**Dimensions**

$r_{min}$	2,1 mm	Minimum chamfer dimension
$D_2$	145,5 mm	Caliber diameter outer ring
$d_1$	108,2 mm	Shoulder diameter inner ring

**Mounting dimensions**

$d_{amin}$	92 mm	Minimum diameter shaft shoulder
$D_{amax}$	158 mm	Maximum diameter of housing shoulder
$r_{amax}$	2,1 mm	Maximum fillet radius

**Calculation factors**

$f_0$	13,3	Calculation factor
-------	------	--------------------

**Temperature range**

$T_{min}$	-20 °C	Operating temperature min.
$T_{max}$	120 °C	Operating temperature max.