

**FAG****6309**

Deep groove ball bearing

Schaeffler ID:  
0167235200000Deep groove ball bearing 63, single row,  
steel sheet metal cage

## Technical information

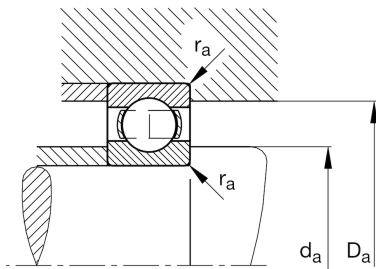
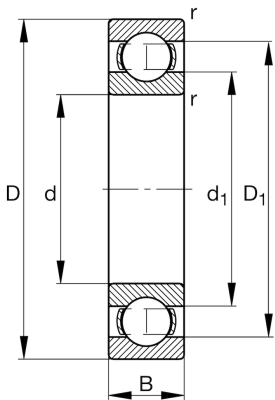

## Dimensions

$r_{\min}$	1,5 mm	Minimum chamfer dimension
$D_1$	83,3 mm	Shoulder diameter outer ring
$d_1$	62,3 mm	Shoulder diameter inner ring
	0,814 kg	Weight

## Main Dimensions &amp; Performance Data

$d$	45 mm	Bore diameter
$D$	100 mm	Outside diameter
$B$	25 mm	Width
$C_r$	56.000 N	Basic dynamic load rating, radial
$C_{0r}$	31.500 N	Basic static load rating, radial
$C_{ur}$	2.240 N	Fatigue load limit, radial
$n_G$	9.500 1/min	Limiting speed
$n_{gr}$	8.200 1/min	Reference speed

## Mounting dimensions

$d_{a\min}$	54 mm	Minimum diameter shaft shoulder
$D_{a\max}$	91 mm	Maximum diameter of housing shoulder
$r_{a\max}$	1,5 mm	Maximum fillet radius

## Calculation factors

$f_0$	12,9	Calculation factor
-------	------	--------------------

## Temperature range

$T_{\min}$	-30 °C	Operating temperature min.
$T_{\max}$	150 °C	Operating temperature max.