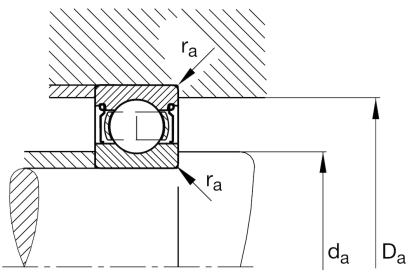
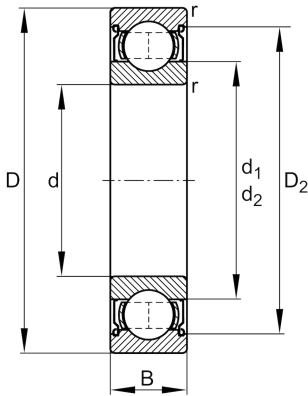
**FAG**★ **626-2Z**

Deep groove ball bearing

Schaeffler ID:  
0383909730000Deep groove ball bearing 62...-2Z, single  
row, shields, steel sheet metal cage

★ Preferred product

## Technical information

**Temperature range**

$T_{\min}$	-30 °C	Operating temperature min.
$T_{\max}$	120 °C	Operating temperature max.
	8 g	Weight

**Main Dimensions & Performance Data**

d	6 mm	Bore diameter
D	19 mm	Outside diameter
B	6 mm	Width
$C_r$	2.614 N	Basic dynamic load rating, radial
$C_{0r}$	1.053 N	Basic static load rating, radial
$C_{ur}$	67 N	Fatigue load limit, radial
$n_G$	45.000 1/min	Limiting speed
$n_{gr}$	30.500 1/min	Reference speed

**Dimensions**

$r_{\min}$	0,3 mm	Minimum chamfer dimension
$D_2$	16,5 mm	Caliber diameter outer ring
$d_2$	8,5 mm	Caliber diameter inner ring

**Mounting dimensions**

$d_{a\min}$	8,4 mm	Minimum diameter shaft shoulder
$D_{a\max}$	16,6 mm	Maximum diameter of housing shoulder
$r_{a\max}$	0,3 mm	Maximum fillet radius

**Calculation factors**

$f_0$	12,3	Calculation factor
-------	------	--------------------