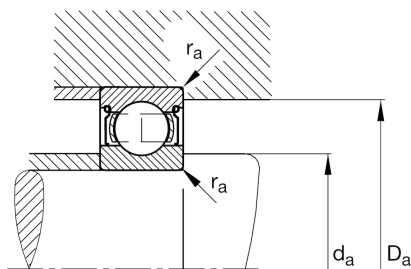
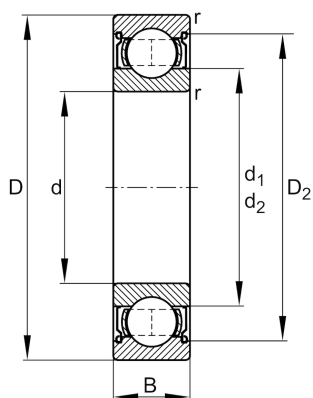

**FAG****6221-2Z**

Deep groove ball bearing

Schaeffler ID:
0191059910000Deep groove ball bearing 62...-2Z, single
row, shields, steel sheet metal cage

Technical information

**Main Dimensions & Performance Data**

d	105 mm	Bore diameter
D	190 mm	Outside diameter
B	36 mm	Width
C_r	141.000 N	Basic dynamic load rating, radial
C_{0r}	105.000 N	Basic static load rating, radial
C_{ur}	5.800 N	Fatigue load limit, radial
n_G	4.000 1/min	Limiting speed
n_{gr}	4.650 1/min	Reference speed
	3,99 kg	{Weight}

Mounting dimensions

$d_{a \min}$	117 mm	Minimum diameter shaft shoulder
$D_{a \max}$	178 mm	Maximum diameter of housing shoulder
$r_{a \max}$	2,1 mm	Maximum fillet radius

Dimensions

r_{\min}	2,1 mm	Minimum chamfer dimension
D_2	168,06 mm	Caliber diameter outer ring
d_1	131,5 mm	Shoulder diameter inner ring

Temperature range

T_{\min}	-20 °C	Operating temperature min.
T_{\max}	120 °C	Operating temperature max.

Calculation factors

f_0	14,4	Calculation factor
-------	------	--------------------