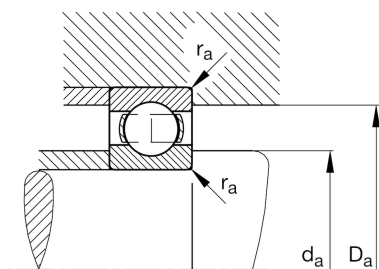
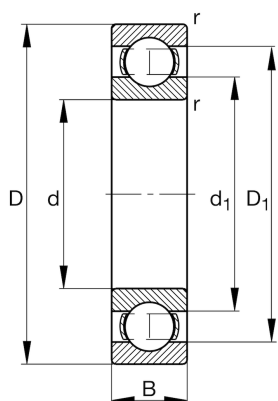

**FAG****61916**

Deep groove ball bearing

Schaeffler ID:
0810038110000Deep groove ball bearing 619, single row,
steel sheet metal cage

Technical information

**Main Dimensions & Performance Data**

d	[80] mm	Bore diameter
D	[110] mm	Outside diameter
B	[16] mm	Width
C_r	[26.500] N	Basic dynamic load rating, radial
C_{0r}	[24.000] N	Basic static load rating, radial
C_{ur}	[1.360] N	Fatigue load limit, radial
n_G	[8.500] 1/min	Limiting speed
n_{gr}	[5.600] 1/min	Reference speed
	[0,39] kg	Weight

Mounting dimensions

$d_{a \min}$	[84,6] mm	Minimum diameter shaft shoulder
$D_{a \max}$	[105,4] mm	Maximum diameter of housing shoulder
$r_{a \max}$	[1] mm	Maximum fillet radius

Dimensions

r_{\min}	[1] mm	Minimum chamfer dimension
D_1	[100,5] mm	Shoulder diameter outer ring
d_1	[89,7] mm	Shoulder diameter inner ring

Temperature range

T_{\min}	[-30] °C	Operating temperature min.
T_{\max}	[150] °C	Operating temperature max.

Calculation factors

f_0	[16,6]	Calculation factor
-------	--------	--------------------