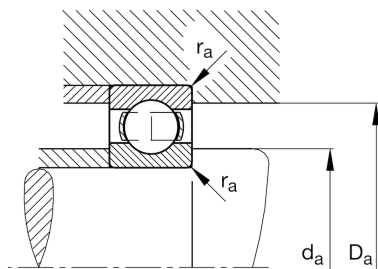
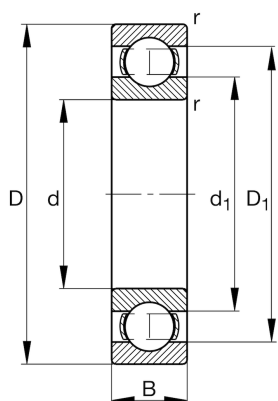

**FAG****61915**

Deep groove ball bearing

Schaeffler ID:
0810028150000Deep groove ball bearing 619, single row,
steel sheet metal cage

Technical information

**Main Dimensions & Performance Data**

d	75 mm	Bore diameter
D	105 mm	Outside diameter
B	16 mm	Width
C_r	26.000 N	Basic dynamic load rating, radial
C_{0r}	22.600 N	Basic static load rating, radial
C_{ur}	1.280 N	Fatigue load limit, radial
n_G	9.000 1/min	Limiting speed
n_{gr}	6.000 1/min	Reference speed
$\approx m$	0,365 kg	Weight

Mounting dimensions

$d_{a \min}$	79,6 mm	Minimum diameter shaft shoulder
$D_{a \max}$	100,4 mm	Maximum diameter of housing shoulder
$r_{a \max}$	1 mm	Maximum fillet radius

Dimensions

r_{\min}	1 mm	Minimum chamfer dimension
D_1	95,3 mm	Shoulder diameter outer ring
d_1	84,7 mm	Shoulder diameter inner ring

Temperature range

T_{\min}	-30 °C	Operating temperature min.
T_{\max}	150 °C	Operating temperature max.

Calculation factors

f_0	16,5	Calculation factor
-------	------	--------------------