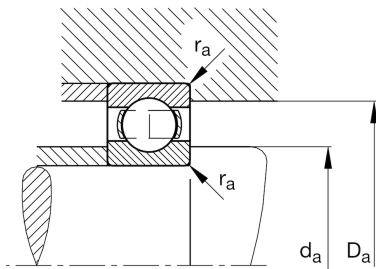
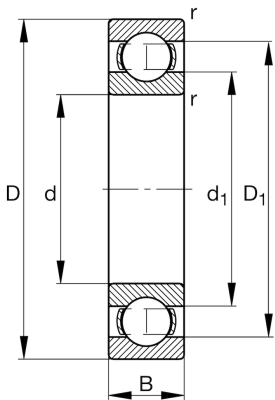

**FAG****61902**

Deep groove ball bearing

Schaeffler ID:
0554920960000Deep groove ball bearing 619, single row,
steel sheet metal cage

Technical information

**Main Dimensions & Performance Data**

d	15 mm	Bore diameter
D	28 mm	Outside diameter
B	7 mm	Width
C_r	4.330 N	Basic dynamic load rating, radial
C_{0r}	2.250 N	Basic static load rating, radial
C_{ur}	132 N	Fatigue load limit, radial
n_G	38.000 1/min	Limiting speed
n_{gr}	20.600 1/min	Reference speed
	0,019 kg	Weight

Mounting dimensions

$d_{a \min}$	17 mm	Minimum diameter shaft shoulder
$D_{a \max}$	26 mm	Maximum diameter of housing shoulder
$r_{a \max}$	0,3 mm	Maximum fillet radius

Dimensions

r_{\min}	0,3 mm	Minimum chamfer dimension
D_1	24,2 mm	Shoulder diameter outer ring
d_1	18,8 mm	Shoulder diameter inner ring

Temperature range

T_{\min}	-30 °C	Operating temperature min.
T_{\max}	120 °C	Operating temperature max.

Calculation factors

f_0	14,3	Calculation factor
-------	------	--------------------