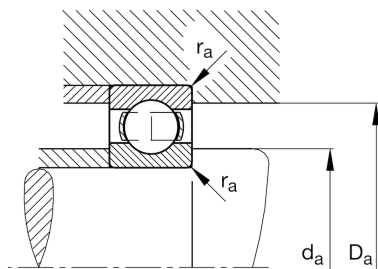
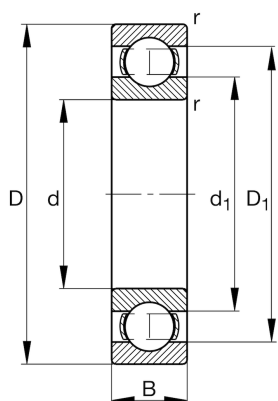

**FAG****61804-HLC-C3**

Deep groove ball bearing

Schaeffler ID:  
0554549330030Deep groove ball bearing 618, single row,  
steel sheet metal cage

## Technical information

**Main Dimensions & Performance Data**

d	20 mm	Bore diameter
D	32 mm	Outside diameter
B	7 mm	Width
$C_r$	4.020 N	Basic dynamic load rating, radial
$C_{0r}$	2.460 N	Basic static load rating, radial
$C_{ur}$	111 N	Fatigue load limit, radial
$n_G$	33.500 1/min	Limiting speed
$n_{gr}$	17.200 1/min	Reference speed
	18 g	{Weight}

**Mounting dimensions**

$d_{a \min}$	22 mm	Minimum diameter shaft shoulder
$D_{a \max}$	30 mm	Maximum diameter of housing shoulder
$r_{a \max}$	0,3 mm	Maximum fillet radius

**Dimensions**

$r_{\min}$	0,3 mm	Minimum chamfer dimension
$D_1$	28,2 mm	Shoulder diameter outer ring
$d_1$	23,2 mm	Shoulder diameter inner ring

**Temperature range**

$T_{\min}$	-30 °C	Operating temperature min.
$T_{\max}$	120 °C	Operating temperature max.

**Calculation factors**

$f_0$	15,4	Calculation factor
-------	------	--------------------