

FAG

61801-2RSR-HLC

Deep groove ball bearing

Schaeffler ID:
0554529490000Deep groove ball bearing 618..-2RSR,
single row, cf. DIN 625-1

Technical information

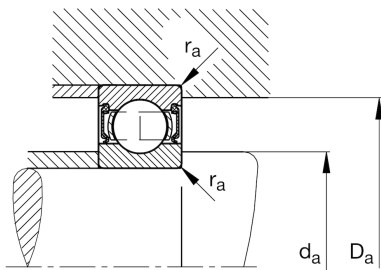
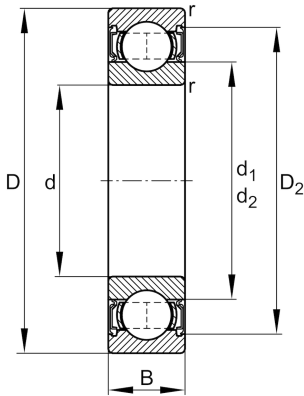
**Main Dimensions & Performance Data**

d	12 mm	Bore diameter
D	21 mm	Outside diameter
B	5 mm	Width
r_{\min}	0,3 mm	Minimum chamfer dimension
C_r	1.920 N	Basic dynamic load rating, radial
C_{0r}	1.040 N	Basic static load rating, radial
C_{ur}	47,5 N	Fatigue load limit, radial
n_G	18.100 1/min	Limiting speed
	0,009 kg	Weight

Dimensions

D_2	19,2 mm	Caliber diameter outer ring
d_2	13,8 mm	Caliber diameter inner ring

Mounting dimensions

$d_{a\min}$	14 mm	Minimum diameter shaft shoulder
$D_{a\max}$	19 mm	Maximum diameter of housing shoulder
$r_{a\max}$	0,3 mm	Maximum fillet radius

Temperature range

T_{\min}	-30 °C	Operating temperature min.
T_{\max}	110 °C	Operating temperature max.

Calculation factors

f_0	15,3	Calculation factor
-------	------	--------------------