

FAG

61800-2RSR-HLC

Deep groove ball bearing

Schaeffler ID:
0554514030000Deep groove ball bearing 618..-2RSR,
single row

Technical information

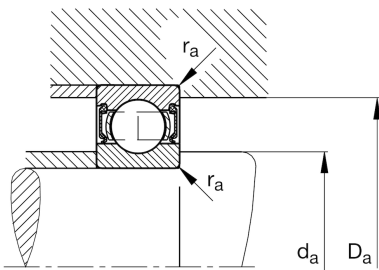
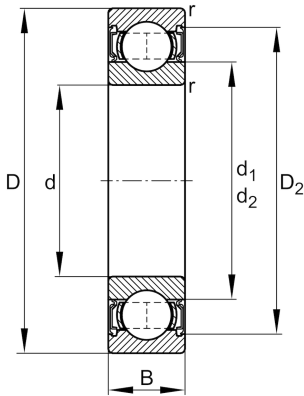
**Main Dimensions & Performance Data**

d	10 mm	Bore diameter
D	19 mm	Outside diameter
B	5 mm	Width
r_{\min}	0.3 mm	Minimum chamfer dimension
C_r	1,720 N	Basic dynamic load rating, radial
C_{0r}	840 N	Basic static load rating, radial
C_{ur}	58 N	Fatigue load limit, radial
n_G	21,000 1/min	Limiting speed
	0.006 kg	Weight

Dimensions

D_2	17.2 mm	Caliber diameter outer ring
d_2	11.8 mm	Caliber diameter inner ring

Mounting dimensions

$d_{a\min}$	12 mm	Minimum diameter shaft shoulder
$D_{a\max}$	17 mm	Maximum diameter of housing shoulder
$r_{a\max}$	0.3 mm	Maximum fillet radius

Calculation factors

f_0	14.8	Calculation factor
-------	------	--------------------

Temperature range

T_{\min}	-30 °C	Operating temperature min.
T_{\max}	110 °C	Operating temperature max.