

FAG

607

Deep groove ball bearing

Schaeffler ID:
0383905900000Deep groove ball bearing 60, single row,
steel sheet metal cage

Technical information

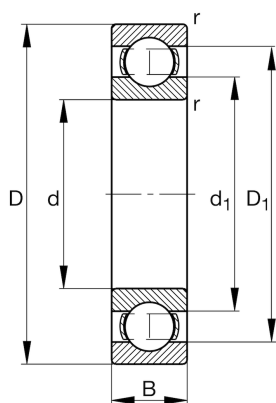

Main Dimensions & Performance Data

| | | |
|----------|--------------|-----------------------------------|
| d | 7 mm | Bore diameter |
| D | 19 mm | Outside diameter |
| B | 6 mm | Width |
| C_r | 2.614 N | Basic dynamic load rating, radial |
| C_{0r} | 1.053 N | Basic static load rating, radial |
| C_{ur} | 55 N | Fatigue load limit, radial |
| n_G | 53.000 1/min | Limiting speed |
| n_{gr} | 35.000 1/min | Reference speed |
| | 8 g | Weight |

Dimensions

| | | |
|-----------|----------|------------------------------|
| r_{min} | 0,3 mm | Minimum chamfer dimension |
| D_1 | 15,5 mm | Shoulder diameter outer ring |
| d_1 | 10,12 mm | Shoulder diameter inner ring |

Mounting dimensions

| | | |
|-------------|--------|--------------------------------------|
| $d_{a min}$ | 9 mm | Minimum diameter shaft shoulder |
| $D_{a max}$ | 17 mm | Maximum diameter of housing shoulder |
| $r_{a max}$ | 0,3 mm | Maximum fillet radius |

Calculation factors

| | | |
|-------|------|--------------------|
| f_0 | 12,3 | Calculation factor |
|-------|------|--------------------|

Temperature range

| | | |
|-----------|--------|----------------------------|
| T_{min} | -30 °C | Operating temperature min. |
| T_{max} | 120 °C | Operating temperature max. |