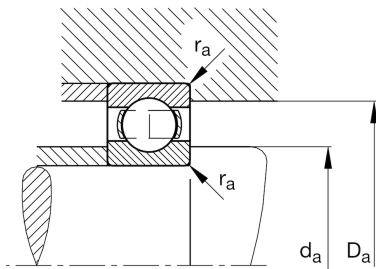
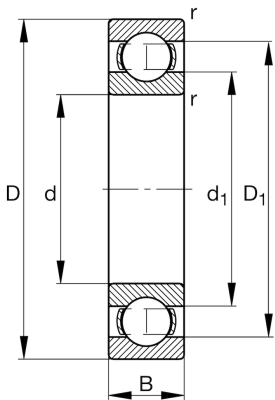

**FAG****6024-C3**

Deep groove ball bearing

Schaeffler ID:
0167184700030Deep groove ball bearing 60, single row,
steel sheet metal cage

Technical information

**Main Dimensions & Performance Data**

d	120 mm	Bore diameter
D	180 mm	Outside diameter
B	28 mm	Width
C_r	88.000 N	Basic dynamic load rating, radial
C_{0r}	77.000 N	Basic static load rating, radial
C_{ur}	3.650 N	Fatigue load limit, radial
n_G	5.000 1/min	Limiting speed
n_{gr}	4.450 1/min	Reference speed
	2,059 kg	{Weight}

Mounting dimensions

$d_{a \min}$	128,8 mm	Minimum diameter shaft shoulder
$D_{a \max}$	171,2 mm	Maximum diameter of housing shoulder
$r_{a \max}$	2 mm	Maximum fillet radius

Dimensions

r_{\min}	2 mm	Minimum chamfer dimension
D_1	161,38 mm	Shoulder diameter outer ring
d_1	139,82 mm	Shoulder diameter inner ring

Temperature range

T_{\min}	-30 °C	Operating temperature min.
T_{\max}	150 °C	Operating temperature max.

Calculation factors

f_0	15,8	Calculation factor
-------	------	--------------------