

FAG

★ 6006-2RSR

Deep groove ball bearing

Schaeffler ID:
0167173500000Deep groove ball bearing 60...-2RSR,
single row, seals, steel sheet metal cage

★ Preferred product

Technical information

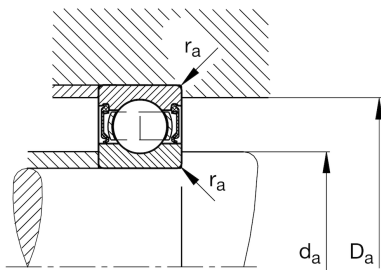
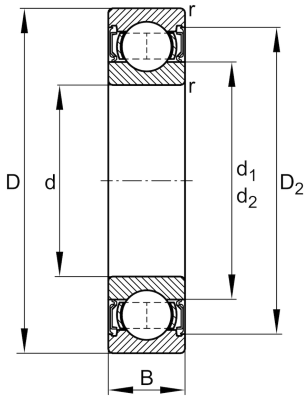

Temperature range

T_{\min}	-20 °C	Operating temperature min.
T_{\max}	110 °C	Operating temperature max.
	0,116 kg	Weight

Main Dimensions & Performance Data

d	30 mm	Bore diameter
D	55 mm	Outside diameter
B	13 mm	Width
C_r	13.500 N	Basic dynamic load rating, radial
C_{0r}	8.000 N	Basic static load rating, radial
C_{ur}	405 N	Fatigue load limit, radial
n_G	7.000 1/min	Limiting speed

Dimensions

r_{\min}	1 mm	Minimum chamfer dimension
D_2	49,2 mm	Caliber diameter outer ring
d_1	38,3 mm	Shoulder diameter inner ring

Mounting dimensions

$d_{a \min}$	34,6 mm	Minimum diameter shaft shoulder
$D_{a \max}$	50,4 mm	Maximum diameter of housing shoulder
$r_{a \max}$	1 mm	Maximum fillet radius

Calculation factors

f_0	14,8	Calculation factor
-------	------	--------------------