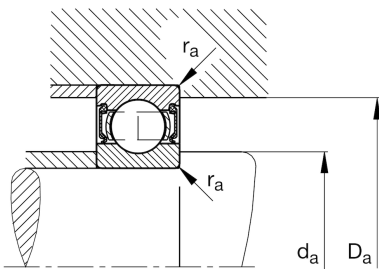
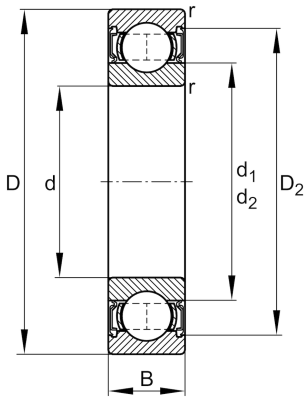

**FAG****6000-2RSR**

Deep groove ball bearing

Schaeffler ID:  
0383904690000Deep groove ball bearing 60...-2RSR,  
single row, cf. DIN 625-1

## Technical information

**Main Dimensions & Performance Data**

d	10 mm	Bore diameter
D	26 mm	Outside diameter
B	8 mm	Width
$r_{\min}$	0,3 mm	Minimum chamfer dimension
$C_r$	4.850 N	Basic dynamic load rating, radial
$C_{0r}$	1.970 N	Basic static load rating, radial
$C_{ur}$	103 N	Fatigue load limit, radial
$n_G$	18.300 1/min	Limiting speed
	20 g	Weight

**Dimensions**

$D_2$	22,5 mm	Caliber diameter outer ring
$d_1$	14,7 mm	Shoulder diameter inner ring

**Mounting dimensions**

$d_{a\min}$	12 mm	Minimum diameter shaft shoulder
$D_{a\max}$	24 mm	Maximum diameter of housing shoulder
$r_{a\max}$	0,3 mm	Maximum fillet radius

**Temperature range**

$T_{\min}$	-20 °C	Operating temperature min.
$T_{\max}$	110 °C	Operating temperature max.

**Calculation factors**

$f_0$	12,4	Calculation factor
-------	------	--------------------