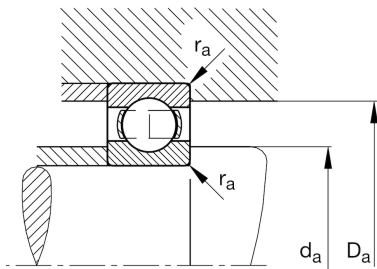
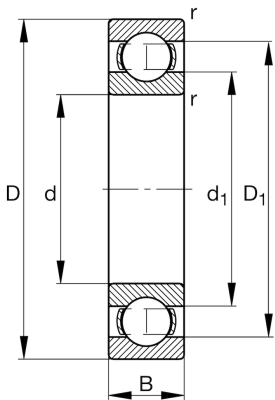

**FAG****16017**

Deep groove ball bearing

Schaeffler ID:
0167011860000Deep groove ball bearing 160, single row,
steel sheet metal cage

Technical information

**Main Dimensions & Performance Data**

d	85,00 mm	Bore diameter
D	130,00 mm	Outside diameter
B	14,00 mm	Width
C_r	36.000,00 N	Basic dynamic load rating, radial
C_{0r}	33.500,00 N	Basic static load rating, radial
C_{ur}	1.900,00 N	Fatigue load limit, radial
n_G	7.400,00 1/min	Limiting speed
n_{gr}	4.400,00 1/min	Reference speed
	0,67 kg	Weight

Mounting dimensions

$d_{a \min}$	88,20 mm	Minimum diameter shaft shoulder
$D_{a \max}$	126,80 mm	Maximum diameter of housing shoulder
$r_{a \max}$	0,60 mm	Maximum fillet radius

Dimensions

r_{\min}	0,60 mm	Minimum chamfer dimension
D_1	114,70 mm	Shoulder diameter outer ring
d_1	100,90 mm	Shoulder diameter inner ring

Temperature range

T_{\min}	-30,00 °C	Operating temperature min.
T_{\max}	150,00 °C	Operating temperature max.

Calculation factors

f_0	16,60	Calculation factor
-------	-------	--------------------