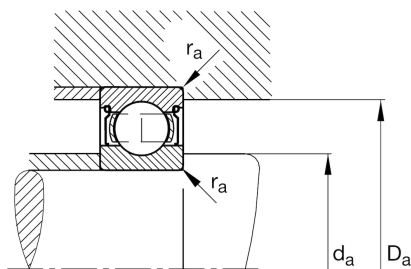
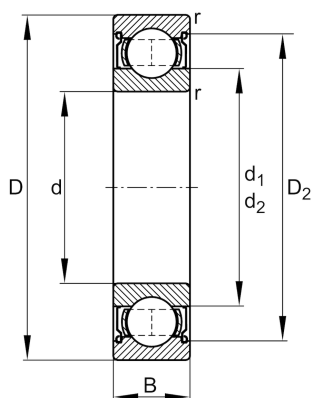

**FAG****6314-2Z-C3**

Deep groove ball bearing

Schaeffler ID:  
0167240380030Deep groove ball bearing 63...-2Z, single  
row, shields, steel sheet metal cage

## Technical information

**Main Dimensions & Performance Data**

d	70 mm	Bore diameter
D	150 mm	Outside diameter
B	35 mm	Width
$C_r$	115.000 N	Basic dynamic load rating, radial
$C_{0r}$	69.000 N	Basic static load rating, radial
$C_{ur}$	4.600 N	Fatigue load limit, radial
$n_G$	5.700 1/min	Limiting speed
$n_{gr}$	6.100 1/min	Reference speed
$\approx m$	2,6 kg	Weight

**Mounting dimensions**

$d_{a \min}$	82 mm	Minimum diameter shaft shoulder
$D_{a \max}$	138 mm	Maximum diameter of housing shoulder
$r_{a \max}$	2,1 mm	Maximum fillet radius

**Dimensions**

$r_{\min}$	2,1 mm	Minimum chamfer dimension
$D_2$	130,18 mm	Caliber diameter outer ring
$d_1$	94,75 mm	Shoulder diameter inner ring

**Temperature range**

$T_{\min}$	-20 °C	Operating temperature min.
$T_{\max}$	120 °C	Operating temperature max.

**Calculation factors**

$f_0$	13,4	Calculation factor
-------	------	--------------------