

**FAG****6304-C-2Z-C3>V**

Deep groove ball bearing

Schaeffler ID:
0949836580030

Deep groove ball bearing 63...-C-2Z, single row, Generation C, shields, steel sheet metal cage

Technical information

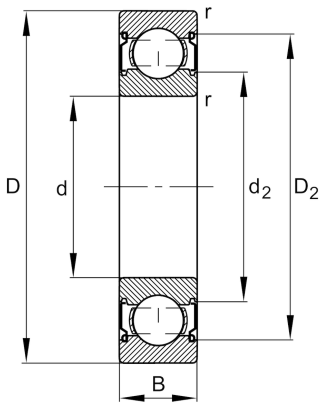
**Main Dimensions & Performance Data**

d	20 mm	Bore diameter
D	52 mm	Outside diameter
B	15 mm	Width
C_r	18.500 N	Basic dynamic load rating, radial
C_{0r}	7.800 N	Basic static load rating, radial
C_{ur}	540 N	Fatigue load limit, radial
n_G	18.700 1/min	Limiting speed
n_{gr}	16.100 1/min	Reference speed
	0,147 kg	{Weight}

Mounting dimensions

$d_{a \min}$	27 mm	Minimum diameter shaft shoulder
$D_{a \max}$	45 mm	Maximum diameter of housing shoulder
$r_{a \max}$	1 mm	Maximum fillet radius

Dimensions

r_{\min}	1,1 mm	Minimum chamfer dimension
D_2	44,12 mm	Caliber diameter outer ring
d_2	27,67 mm	Caliber diameter inner ring

Temperature range

T_{\min}	-20 °C	Operating temperature min.
T_{\max}	120 °C	Operating temperature max.

Calculation factors

f_0	12,3	Calculation factor
-------	------	--------------------

