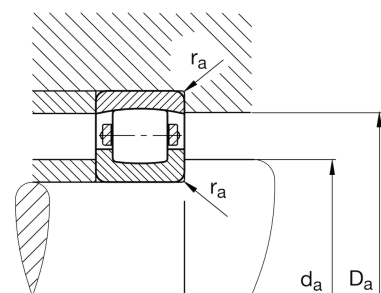
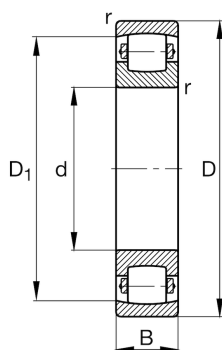
**FAG****20305-TVP**

Barrel roller bearing

Schaeffler ID:
0167020690000Barrel roller bearings 203, main
dimensions to DIN 635-1

Technical information

**Main Dimensions & Performance Data**

d	[25] mm	Bore diameter
D	[62] mm	Outside diameter
B	[17] mm	Width
C_r	[36.000] N	Basic dynamic load rating, radial
C_{0r}	[35.000] N	Basic static load rating, radial
C_{ur}	[3.050] N	Fatigue load limit, radial
n_G	[9.800] 1/min	Limiting speed
	[250] g	Weight

Mounting dimensions

$d_{a \min}$	[32] mm	Minimum diameter shaft shoulder
$D_{a \max}$	[55] mm	Maximum diameter of housing shoulder
$r_{a \max}$	[1] mm	Maximum recess radius

Dimensions

r_{\min}	[1,1] mm	Minimum chamfer dimension
D_1	[51,9] mm	Bore diameter outer ring

Temperature range

T_{\min}	[-30] °C	Operating temperature min.
T_{\max}	[120] °C	Operating temperature max.