



FAG

6304-TVH-C3

Deep groove ball bearing

Schaeffler ID:
0383771790030Deep groove ball bearing 63...TVH, single
row, plastic cage

Technical information

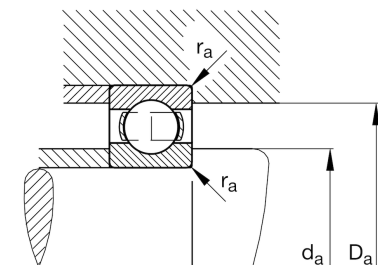
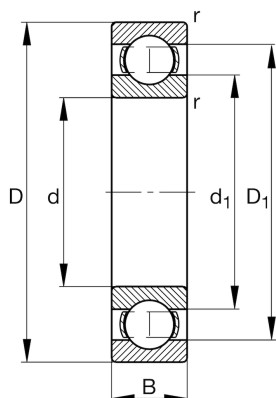
**Main Dimensions & Performance Data**

| | | |
|----------|--------------|-----------------------------------|
| d | 20 mm | Bore diameter |
| D | 52 mm | Outside diameter |
| B | 15 mm | Width |
| C_r | 16.900 N | Basic dynamic load rating, radial |
| C_{0r} | 7.900 N | Basic static load rating, radial |
| C_{ur} | 540 N | Fatigue load limit, radial |
| n_G | 19.800 1/min | Limiting speed |
| n_{gr} | 14.400 1/min | Reference speed |
| | 0,14 kg | Weight |

Mounting dimensions

| | | |
|--------------|--------|--------------------------------------|
| $d_{a \min}$ | 27 mm | Minimum diameter shaft shoulder |
| $D_{a \max}$ | 45 mm | Maximum diameter of housing shoulder |
| $r_{a \max}$ | 1,1 mm | Maximum fillet radius |

Dimensions

| | | |
|------------|---------|------------------------------|
| r_{\min} | 1,1 mm | Minimum chamfer dimension |
| D_1 | 41,9 mm | Shoulder diameter outer ring |
| d_1 | 30,3 mm | Shoulder diameter inner ring |

Temperature range

| | | |
|------------|--------|----------------------------|
| T_{\min} | -30 °C | Operating temperature min. |
| T_{\max} | 120 °C | Operating temperature max. |

Calculation factors

| | | |
|-------|------|--------------------|
| f_0 | 12,4 | Calculation factor |
|-------|------|--------------------|