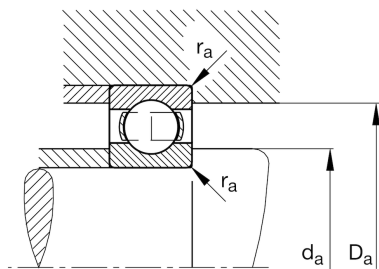
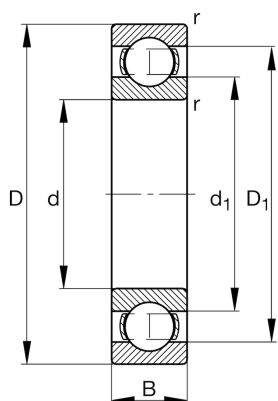

**FAG****61800**

Deep groove ball bearing

Schaeffler ID:  
0554522130000Deep groove ball bearing 618, single row,  
steel sheet metal cage

## Technical information

**Main Dimensions & Performance Data**

d	10 mm	Bore diameter
D	19 mm	Outside diameter
B	5 mm	Width
$C_r$	1.720 N	Basic dynamic load rating, radial
$C_{0r}$	840 N	Basic static load rating, radial
$C_{ur}$	58 N	Fatigue load limit, radial
$n_G$	54.000 1/min	Limiting speed
$n_{gr}$	27.500 1/min	Reference speed
	6 g	Weight

**Mounting dimensions**

$d_{a \min}$	11 mm	Minimum diameter shaft shoulder
$D_{a \max}$	18 mm	Maximum diameter of housing shoulder
$r_{a \max}$	0,3 mm	Maximum fillet radius

**Dimensions**

$r_{\min}$	0,3 mm	Minimum chamfer dimension
------------	--------	---------------------------

**Temperature range**

$T_{\min}$	-30 °C	Operating temperature min.
$T_{\max}$	120 °C	Operating temperature max.

**Calculation factors**

$f_0$	14,8	Calculation factor
-------	------	--------------------