



**Technical data**

**2207KC3**

Double-row self-aligning ball bearings

Self-aligning ball bearing, pressed steel cage, tapered bore, open

**VISUAL (S)**

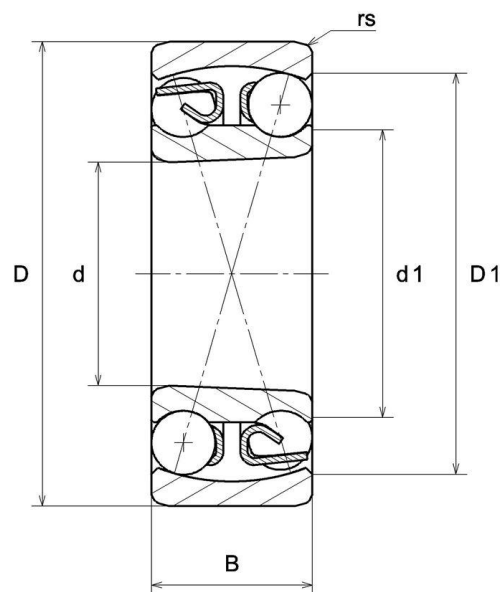
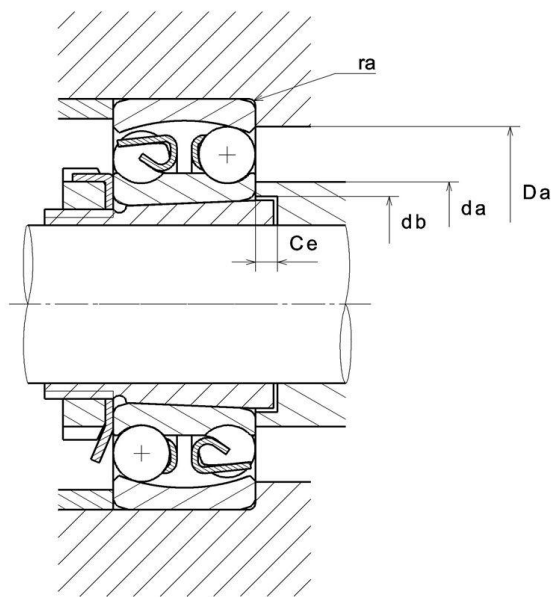

# 2207KC3

Double-row self-aligning ball bearings

## PRODUCT DIMENSIONS

<b>d - Internal diameter</b>	35 mm
<b>D - External diameter</b>	72 mm
<b>B - Bearing/Inner ring width</b>	23 mm
<b>d1 - External diameter inner ring</b>	46,2 mm
<b>D1 - Inner diameter outer ring</b>	59,8 mm
<b>rs - Min fillet radius</b>	1,1 mm
<b>Associated sleeve reference</b>	H307
<b>Radial clearance class</b>	C3
<b>Precision class</b>	P0
<b>Mass</b>	0,391 kg
<b>Brand</b>	SNR

## PRODUCT PERFORMANCE

<b>C - Dynamic load</b>	21,2 kN
<b>C0 - Static load</b>	6,6 kN
<b>Cu - Fatigue limit load</b>	0,3 kN
<b>e - Coefficient</b>	0.37
<b>Y0 - Static axial load coefficient</b>	1.77
<b>Y1 - Lower axial load coefficient</b>	1.69
<b>Y2 - Upper axial load coefficient</b>	2.62
<b>Nref - Reference thermal speed</b>	10000 tr/min
<b>Nlim - Mechanical Limit Speed</b>	12000 tr/min
<b>Tmin - Min operating temperature</b>	-40 °C
<b>Tmax - Max operating temperature</b>	120 °C

# 2207KC3

Double-row self-aligning ball bearings

ABUTMENT	
<b>da min - Min shoulder diameter IR</b>	41,5 mm
<b>da max - Max shoulder diameter IR</b>	45 mm
<b>db - Min diameter for Sleeve</b>	39 mm
<b>Ce - Min length fro Sleeve</b>	5 mm
<b>Da max - Max shoulder diameter OR</b>	65,5 mm
<b>ra max - Max shaft &amp; housing fillet radius</b>	1 mm