



## Technical data

**NJ2209**

Single row cylindrical roller bearings

Single row cylindrical roller bearing, single direction for axial loads, separable, pressed steel cage.

### VISUAL (S)

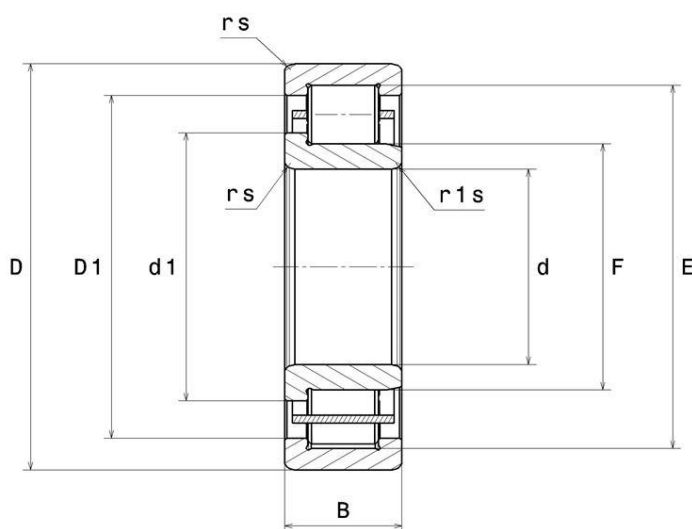
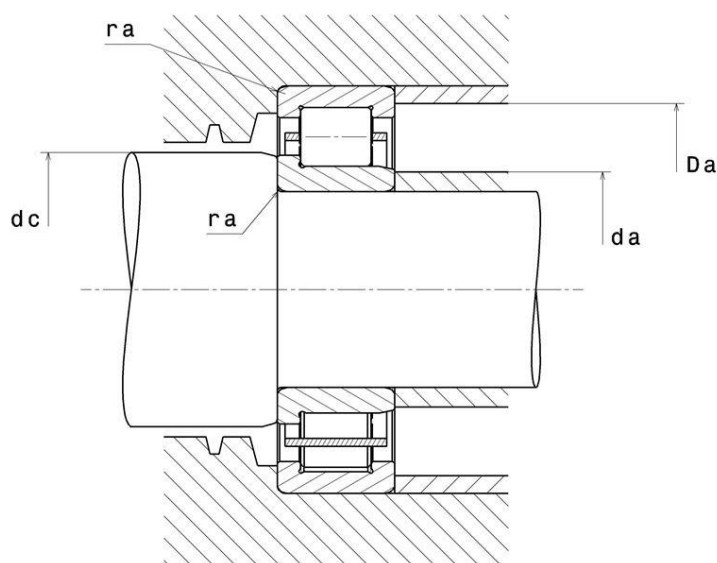

### PRODUCT DIMENSIONS

<b>Internal diameter d</b>	45 mm
<b>External diameter D</b>	85 mm
<b>Bearing/Inner ring width(B)</b>	23 mm
<b>Upper roller diameter E</b>	75 mm
<b>Under roller diameter F</b>	55 mm
<b>d1</b>	59 mm
<b>Min fillet radius rs</b>	1,1 mm
<b>Min fillet radius r1s</b>	1,1 mm
<b>Radial clearance class</b>	CN
<b>Mass</b>	0,57 kg
<b>Brand</b>	NTN

### PRODUCT PERFORMANCE

<b>Dynamic load, C</b>	68 kN
<b>Static load, C0</b>	68 kN
<b>Fatigue limit load, Cu</b>	8,25 kN
<b>Nlim (oil)</b>	9000 tr/min
<b>Nlim (grease)</b>	7600 tr/min
<b>Min operating temperature, Tmin</b>	-40 °C
<b>Max operating temperature, Tmax</b>	120 °C
<b>Characteristic cage frequency, FTF</b>	0.423 Hz
<b>Characteristic rolling element frequency, BSF</b>	6.346 Hz
<b>Characteristic outer ring frequency, BPF0</b>	5.923 Hz
<b>Characteristic inner ring frequency, BRF0</b>	8.077 Hz

### ABUTMENT

<b>Min shoulder diameter IR da min</b>	51,5 mm
<b>Small face shoulder max diameter da max</b>	54 mm
<b>Min NJ &amp; N type IR GO diameter dc min</b>	61 mm
<b>Max shoulder diameter OR Da max</b>	78,5 mm
<b>Max fillet radius ra max</b>	1 mm

## INDUSTRY CALCUL FACTORS

### Equivalent dynamic radial load

$$P = Fr$$

### Equivalent static radial load

$$P_0 = Fr$$