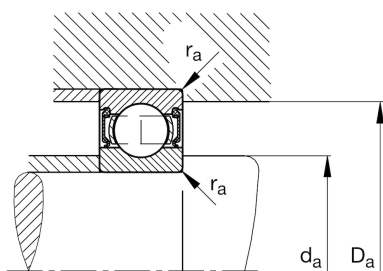
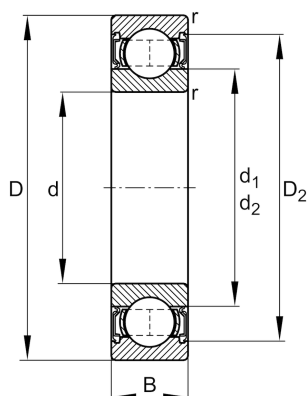

**FAG****63001-A-2RSR-C3**

Deep groove ball bearing

Schaeffler ID:
0599755200030Deep groove ball bearing 630..-A-2RSR,
single row, seals, steel sheet metal cage

Technical information

**Main Dimensions & Performance Data**

d	12 mm	Bore diameter
D	28 mm	Outside diameter
B	12 mm	Width
C_r	5.100 N	Basic dynamic load rating, radial
C_{0r}	2.370 N	Basic static load rating, radial
C_{ur}	161 N	Fatigue load limit, radial
n_G	15.500 1/min	Limiting speed
	29 g	Weight

Mounting dimensions

$d_{a \min}$	14 mm	Minimum diameter shaft shoulder
$D_{a \max}$	26 mm	Maximum diameter of housing shoulder
$r_{a \max}$	0,3 mm	Maximum fillet radius

Dimensions

r_{\min}	0,3 mm	Minimum chamfer dimension
D_2	25,49 mm	Caliber diameter outer ring
d_1	17,2 mm	Shoulder diameter inner ring

Temperature range

T_{\min}	-20 °C	Operating temperature min.
T_{\max}	100 °C	Operating temperature max.

Calculation factors

f_0	13,1	Calculation factor
-------	------	--------------------