



FAG

★ 6217

Deep groove ball bearing

Schaeffler ID:
0167214380000Deep groove ball bearing 62, single row,
steel sheet metal cage

★ Preferred product

Technical information

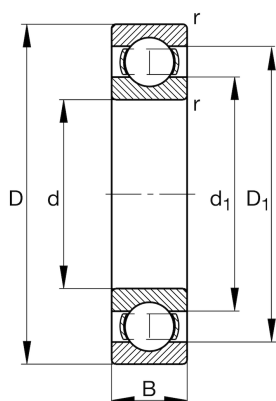

Main Dimensions & Performance Data

d	85 mm	Bore diameter
D	150 mm	Outside diameter
B	28 mm	Width
C_r	89.000 N	Basic dynamic load rating, radial
C_{0r}	64.000 N	Basic static load rating, radial
C_{ur}	4.050 N	Fatigue load limit, radial
n_G	6.700 1/min	Limiting speed
n_{gr}	5.300 1/min	Reference speed
	1,798 kg	Weight

Dimensions

r_{min}	2 mm	Minimum chamfer dimension
D_1	129,8 mm	Shoulder diameter outer ring
d_1	106,6 mm	Shoulder diameter inner ring

Mounting dimensions

$d_{a min}$	96 mm	Minimum diameter shaft shoulder
$D_{a max}$	139 mm	Maximum diameter of housing shoulder
$r_{a max}$	2 mm	Maximum fillet radius

Calculation factors

f_0	14,8	Calculation factor
-------	------	--------------------

Temperature range

T_{min}	-30 °C	Operating temperature min.
T_{max}	150 °C	Operating temperature max.