

FAG

6322-2Z

Deep groove ball bearing

Schaeffler ID:
0191117700000Deep groove ball bearing 63...-2Z, single
row, shields, steel sheet metal cage

Technical information

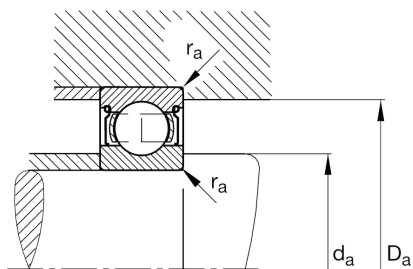
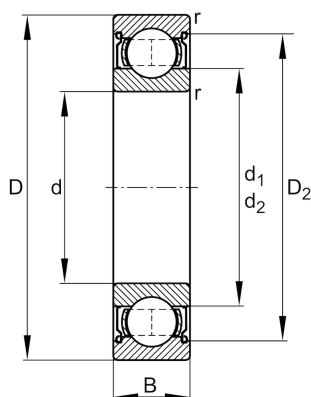
**Dimensions**

r_{\min}	3 mm	Minimum chamfer dimension
D_2	203,1 mm	Caliber diameter outer ring
d_1	152,9 mm	Shoulder diameter inner ring
	9,981 kg	Weight

Main Dimensions & Performance Data

d	110 mm	Bore diameter
D	240 mm	Outside diameter
B	50 mm	Width
C_r	201.000 N	Basic dynamic load rating, radial
C_{0r}	165.000 N	Basic static load rating, radial
C_{ur}	8.800 N	Fatigue load limit, radial
n_G	3.250 1/min	Limiting speed
n_{gr}	4.150 1/min	Reference speed

Mounting dimensions

$d_{a\min}$	124 mm	Minimum diameter shaft shoulder
$D_{a\max}$	226 mm	Maximum diameter of housing shoulder
$r_{a\max}$	2,5 mm	Maximum fillet radius

Calculation factors

f_0	13,8	Calculation factor
-------	------	--------------------

Temperature range

T_{\min}	-20 °C	Operating temperature min.
T_{\max}	120 °C	Operating temperature max.