

**FAG****6319**

Deep groove ball bearing

Schaeffler ID:  
0167243480000Deep groove ball bearing 63, single row,  
steel sheet metal cage

## Technical information

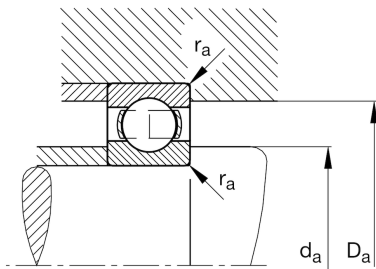
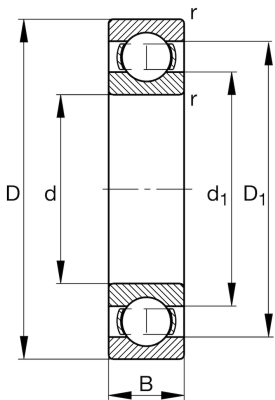

## Main Dimensions &amp; Performance Data

d	95 mm	Bore diameter
D	200 mm	Outside diameter
B	45 mm	Width
$C_r$	154.000 N	Basic dynamic load rating, radial
$C_{0r}$	113.000 N	Basic static load rating, radial
$C_{ur}$	6.600 N	Fatigue load limit, radial
$n_G$	4.600 1/min	Limiting speed
$n_{gr}$	4.950 1/min	Reference speed
	6,23 kg	{Weight}

## Mounting dimensions

$d_{a \min}$	109 mm	Minimum diameter shaft shoulder
$D_{a \max}$	186 mm	Maximum diameter of housing shoulder
$r_{a \max}$	2,5 mm	Maximum fillet radius

## Dimensions

$r_{\min}$	3 mm	Minimum chamfer dimension
$D_1$	166,88 mm	Shoulder diameter outer ring
$d_1$	129,08 mm	Shoulder diameter inner ring

## Temperature range

$T_{\min}$	-30 °C	Operating temperature min.
$T_{\max}$	150 °C	Operating temperature max.

## Calculation factors

$f_0$	13,8	Calculation factor
-------	------	--------------------