



PME35-XL-N

Flanged housing unit

Schaeffler ID:
0096437020000

Housing units PME, four-bolt flanged housing units, cast iron, centring spigot, eccentric locking collar, P seals

X-life

Technical information

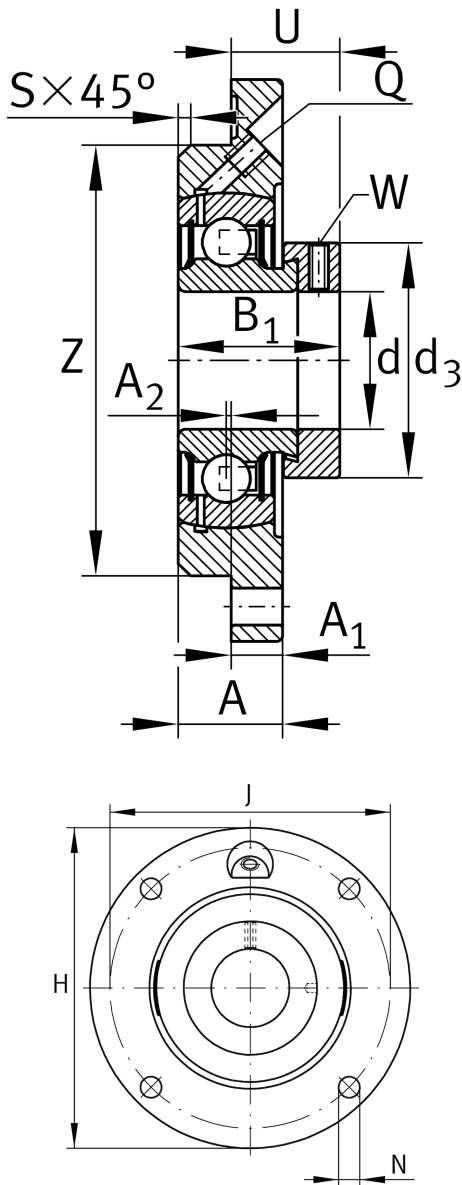

Dimensions

A	20,5 mm	Height housing
A ₁	10 mm	Thickness of flange
A ₂	1 mm	Distance raceway
S	2 mm	Chamfer width
Q	M6	Connection thread lubrication
	1,27 kg	Weight

Main Dimensions & Performance Data

d	35 mm	Bore diameter
H	135 mm	Height flange
B ₁	39 mm	Locking collar total width
U	28,5 mm	Total height unit
C _r	25.500 N	Basic dynamic load rating, radial
C _{0r}	15.300 N	Basic static load rating, radial
C _{ur}	650 N	Fatigue load limit, radial

Mounting dimensions

J	110 mm	Pitch circle diameter (holes)
N	11,5 mm	Fixing bore
T ₁	10,5 mm	Height spigot
Z	90 mm	Diameter spigot
	h8	Diameter spigot clearance
n	4	Number of screwing holes

Additional information

1	Number of housings
ME07	Housing
GRAE35-XL-NPP-B	Bearing designation
KASK07	Protecting cap