



FAG

★ NJ303-E-XL-TVP2

Cylindrical roller bearing

Schaeffler ID:
0167359940000

★ Preferred product

Cylindrical roller bearing NJ..-E-XL-TVP2,
with cage, single row, semi-locating
bearing, 2 ribs on outer ring, 1 rib on inner
ring, type NJ

X-life

Technical information

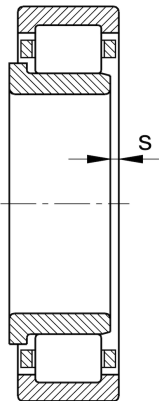
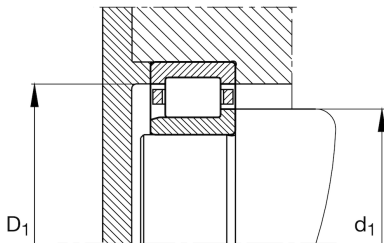
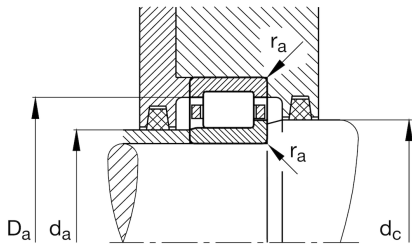

Main Dimensions & Performance Data

d	17 mm	Bore diameter
D	47 mm	Outside diameter
B	14 mm	Width
C_r	30.000 N	Basic dynamic load rating, radial
C_{0r}	21.200 N	Basic static load rating, radial
C_{ur}	3.400 N	Fatigue load limit, radial
n_G	19.600 1/min	Limiting speed
n_{gr}	13.500 1/min	Reference speed
	0,124 kg	Weight

Dimensions

	HJ303-E	L-washer
r_{min}	1 mm	Minimum chamfer dimension
r_{1min}	0,6 mm	Minimum chamfer dimension
s	1,2 mm	Axial displacement
E	40,2 mm	Raceway diameter outer ring
F	24,2 mm	Raceway diameter inner ring
D_{1min}	37,1 mm	Minimum rib diameter outer ring
d_1	27,6 mm	Maximum rib diameter inner ring

Mounting dimensions

d_{amin}	21,2 mm	Minimum diameter shaft shoulder
d_{amax}	23,5 mm	Maximum diameter of shaft shoulder
D_{amax}	42,8 mm	Maximum diameter of housing shoulder
d_{cmin}	28 mm	Minimum shaft shoulder
r_{amax}	1 mm	Maximum recess radius

Temperature range

T_{min}	-30 °C	Operating temperature min.
T_{max}	120 °C	Operating temperature max.

