

## Technical information

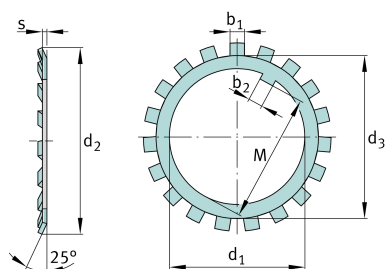

### Main Dimensions & Performance Data

$d_1$	20 mm	bore diameter
$d_2$	36 mm	Outside diameter
$s$	1 mm	Thickness
	3,2 g	Weight

### Mounting dimensions

$d_3$	26 mm	Plant diameter outside
$b_2$	4 mm	Distance lug
$M$	18,5 mm	Distance lug
$b_1$	4 mm	Width lock washer tab

### Additional information

	100	Counted quantity
--	-----	------------------