

## Technical information

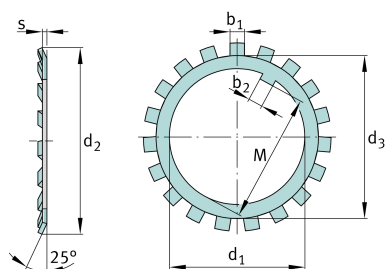

### Main Dimensions & Performance Data

$d_1$	110 mm	bore diameter
$d_2$	154 mm	Outside diameter
$s$	1,75 mm	Thickness
	0,091 kg	Weight

### Mounting dimensions

$d_3$	133 mm	Plant diameter outside
$b_2$	12 mm	Distance lug
$M$	105,5 mm	Distance lug
$b_1$	12 mm	Width lock washer tab

### Additional information

	100	Counted quantity
--	-----	------------------