

Technical information

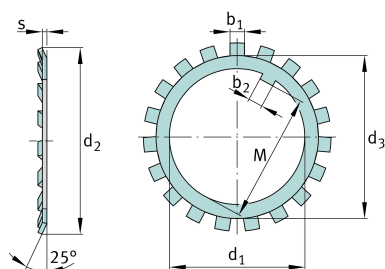

Main Dimensions & Performance Data

d_1	105 mm	bore diameter
d_2	145 mm	Outside diameter
s	1,75 mm	Thickness
	81,9 g	Weight

Mounting dimensions

d_3	126 mm	Plant diameter outside
b_2	12 mm	Distance lug
M	100,5 mm	Distance lug
b_1	12 mm	Width lock washer tab

Additional information

	100	Counted quantity
--	-----	------------------