

KRV22-PP

Yoke type track roller

Schaeffler ID:
0057456590000

Stud type track rollers KRV...-PP, with axial guidance, full complement needle roller set, plastic axial plain washers on both sides

Technical information

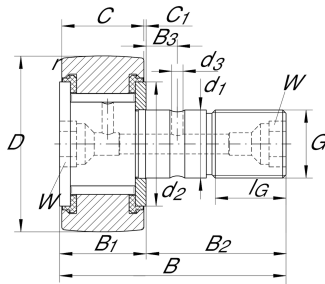

Main Dimensions & Performance Data

D	22 mm	Outside diameter
d ₁	10 mm	Fit diameter of roller stud / stud
B	36 mm	Width
C _{r w}	6.200 N	Basic dynamic load rating, radial
C _{0r w}	9.300 N	Basic static load rating, radial
C _{ur w}	1.230 N	Fatigue load limit, radial
n _{D G}	2.600 1/min	Speed on permanent grease lubrication
≈m	44 g	Weight

Dimensions

B ₁	13,2 mm	Width of thrust washer
B ₂	23 mm	Bolt/stud length effectively
C	12 mm	Width, outer ring
C ₁	0,6 mm	Protrusion outer ring to thrust washer
r _{min}	0,3 mm	Minimum chamfer dimension
d ₂	17,5 mm	Stop diameter of thrust washer
G	M10X1	Thread
l _G	12 mm	Thread length
W	5 mm	Width of flats

Additional information

	NIPA1X4,5	Drive-fit lubrication nipple
M _A	15 Nm	Tightening torque nut