

**FAG**★ **KM16**

Locknut

Schaeffler ID:
0167319210000

Locknuts KM, main dimensions to DIN 981

★ Preferred product

Technical information

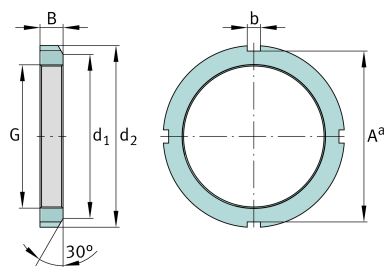
**Main Dimensions & Performance Data**

G	M80x2	Thread
d ₂	105 mm	Outsidediameter
B	15 mm	Width
	0,004 kg	Weight

Mounting dimensions

d ₁	95 mm	Chamfer diameter
b	8 mm	Width retaining slot
A ^a	98 mm	Groove base distance

Additional information

F	190.000 N	Axial load capacity, static
	MB16	Fuse
	30 °	Chamfer angle