

FAG

★ KM12

Locknut

Schaeffler ID:
0167318830000

Locknuts KM, main dimensions to DIN 981

★ Preferred product

Technical information

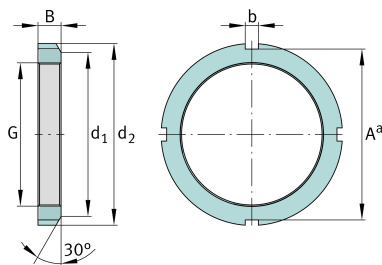

Main Dimensions & Performance Data

G	M60x2	Thread
d ₂	80 mm	Outsides diameter
B	11 mm	Width
	0,002 kg	Weight

Mounting dimensions

d ₁	73 mm	Chamfer diameter
b	7 mm	Width retaining slot
A ^a	74 mm	Groove base distance

Additional information

F	90.000 N	Axial load capacity, static
	MB12	Fuse
	30 °	Chamfer angle