

**FAG**★ **KM11**

Locknut

Schaeffler ID:  
0167318750000

Locknuts KM, main dimensions to DIN 981

★ Preferred product

## Technical information

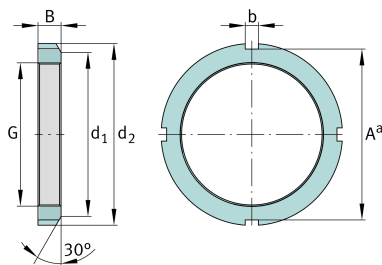
**Main Dimensions & Performance Data**

G	M55x2	Thread
d <sub>2</sub>	75 mm	Outsides diameter
B	11 mm	Width
	0,002 kg	Weight

**Mounting dimensions**

d <sub>1</sub>	67 mm	Chamfer diameter
b	7 mm	Width retaining slot
A <sup>a</sup>	69 mm	Groove base distance

**Additional information**

F	87.000 N	Axial load capacity, static
	MB11	Fuse
	30 °	Chamfer angle