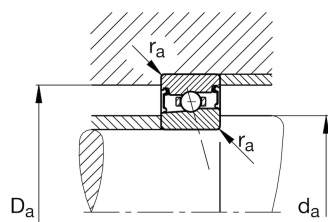
**FAG****HSS71903-E-T-P4S-UL**

Angular contact ball bearing

Schaeffler ID:
0191855530000Spindle bearings HSS719..-E, adjusted,
in pairs or sets, contact angle $\alpha = 25^\circ$, lip
seals on both sides, non-contact, restricted
tolerances

Technical information

**Main Dimensions & Performance Data**

d	17 mm	Bore diameter
D	30 mm	Outside diameter
B	7 mm	Width
C_r	2.480 N	Basic dynamic load rating, radial
C_{0r}	1.070 N	Basic static load rating, radial
C_{ur}	114 N	Fatigue load limit, radial
$n_{G \text{ Grease}}$	63.000 1/min	Limiting speed for grease lubrication
	22 g	Weight

Dimensions

r_{\min}	0,3 mm	Minimum chamfer dimension
$r_{1 \min}$	0,3 mm	Minimum chamfer dimension
α	25°	Contact angle

Mounting dimensions

d_a	20 mm	Diameter shaft shoulder
d_a	h12	Diameter shaft shoulder clearance
D_a	27,5 mm	Shoulder diameter outer ring
D_a	H12	Shoulder diameter outer ring clearance
$r_{a \max}$	0,3 mm	Maximum recess radius
$r_{a1 \max}$	0,1 mm	Maximum recess radius
a	9 mm	Distance between the apices of the pressure cones

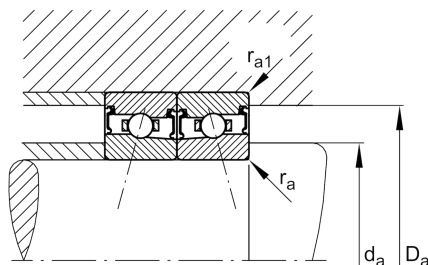

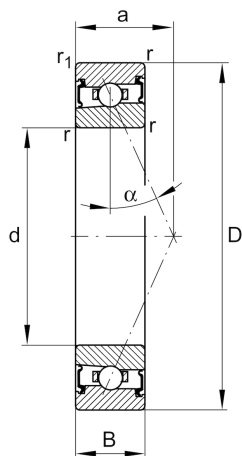

Additional information

F_{VL}	16 N	Preload force light
F_{VM}	47 N	Preload force medium
F_{VH}	93 N	Preload force heavy
K_{aEL}	45 N	Lift-off force light
K_{aEM}	138 N	Lift-off force medium
K_{aEH}	283 N	Lift-off force heavy
c_{aL}	29,6 N/ μm	Axial rigidity light
c_{aM}	44,4 N/ μm	Axial rigidity medium
c_{aH}	58,3 N/ μm	Axial rigidity heavy